

IMPLANT CATALOGUE



MENTOR[®]
BREAST IMPLANTS



 **MENTOR**[®]

Make life more beautiful™

www.mentormedical.co.uk
Customer Service 0800 973 082
contact@medgb.jnj.com

Our commitment to you: the highest standard of quality, proven safe and effective clinical outcomes and differentiated service, everyday.

It is at the core of who we are as the leader in breast aesthetics¹, built upon our 50 year² dedication and our long term commitment to advance plastic surgery to restore body and life.

MENTOR IS COMMITTED TO PROVIDING THE HIGHEST STANDARD OF **QUALITY**

Our focused experience in breast implants gives the consistency, trust and peace of mind that you expect and rely on.

We believe so strongly in our products that we stand behind you with a lifetime product replacement policy.

- Leading innovation in manufacturing
 - Our advanced manufacturing facility in the Netherlands uses automated dipping to ensure consistency from implant to implant.³
- Through rigorous scientific testing, Mentor meets and exceeds the strictest quality control standards to ensure each implant delivers what each surgeon and patient has trusted over the last 50 years
- Our breast implants meet all applicable global standards and regulations including CE mark approval under the Medical Device Directive 93/42/EEC , US FDA approval and ISO 10993:1, ISO 14607 and ISO 13485⁴
- Mentor's products continue to keep pace with the expectations of surgeons and women who desire a safe, soft gel to retain the natural feel that resembles actual breast tissue. Our proprietary gel and shell design make the difference.⁵
- Mentor's patented SILTEX® Texturing process does not use salt or sugar crystals and creates a surface substantially free of pores to prevent pooling of body fluids.⁶

MENTOR IS COMMITTED TO PROVIDING YOU WITH OBJECTIVE, EVIDENCE BASED CLINICAL INFORMATION ABOUT BREAST IMPLANT SAFETY **OUTCOME**

- We studied over 200,000 patients in 7 studies to provide a significant body of clinical evidence leading to FDA approvals for MemoryGel™ and saline implants, demonstrating the safety and efficacy of our leading breast implant portfolio⁷

- The extensive safety and effectiveness data on our products have supported approvals in 100 countries around the world⁸
- 20 years of clinical data has demonstrated safety, effectiveness and high patient satisfaction. Our implants have been the leading choice for millions of women worldwide.⁹



MENTOR IS COMMITTED TO SUPPORTING AND PARTNERING WITH YOU AND WE PROVIDE YOU THE BROADEST RANGE OF PRODUCTS AND SERVICES.



- We are dedicated to partnering and providing the expertise needed to help you differentiate your practice
- Mentor Professional Education provides you the means to achieve excellence through better patient outcomes
- From our customer service to our policies and procedure, we aim to exceed your expectations in working with Mentor



1-3, 5, 7-9 Data on File at Mentor Worldwide LLC . 4. Council Directive 93/42/EEC of 14 June 1993 concerning medical devices, updated 2007 / FDA Approval for MENTOR® MemoryGel™ Round Profile Cohesive I™ Breast Implants and MENTOR® Saline-Filled Breast Implants / ISO 10993:1 "Biological Evaluation of Medical Devices" - International Organization for Standardization, Geneva, Switzerland. / Ibid - ISO 14607 "Non-active surgical implants - Mammary Implants - Particular requirements" / Ibid - "Medical devices - Quality management systems - Requirements for regulatory purposes" 6. Patent US 2003/014948 A1



PatientCare Promise

LIMITED WARRANTY PLAN FOR MENTOR® AND PERTHESE™ SILICONE GEL-FILLED BREAST IMPLANTS*

YOU CAN'T PUT A PRICE ON PEACE OF MIND.
SO NEITHER HAVE WE.

PatientCare Promise means extra peace of mind for your Mentor® and PERTHESE™ Silicone Gel-filled Breast Implants**

- Free automatic enrolment
- Lifetime product replacement in case of confirmed rupture
- In the case of confirmed rupture, up to €1000 of financial assistance, for a period of 10 years from the date of its implantation
- Free product replacement in the case of confirmed capsular contracture Baker grade III and IV in augmentation surgery, for a period of 10 years from the date of its implantation

DATA PROTECTION

In order to assess your eligibility for PatientCare Promise for MENTOR® and PERTHESE™ Silicone Gel-filled Breast Implants, and to provide replacement product and financial assistance, Mentor Medical Systems C.V. will, through its local operations, collect the following information about you: name, address, date of implantation, product serial number and other product details, as well as other personal details that you may wish to provide. Mentor will not share the information with parties other than your medical health or insurance providers, except where required for legal or regulatory compliance or litigation. Mentor will retain the information for the duration of your use of the silicone gel-filled breast implants, unless a longer retention period is required or permitted by law.

You may also obtain a copy of the complete Mentor PatientCare Promise limited warranty by going to www.mentorwllc.eu or by writing to Mentor, Johnson & Johnson Medical limited; Pinewood Campus, Nine Mile Ride, Wokingham, Berkshire, RG40 3EW, UK.

Warranties and representations contained herein are given jointly by Mentor and Perouse Plastique; both parties may be jointly referred to in the text as "Mentor"

** For all other MENTOR® and PERTHESE™ Breast Implants, please refer to the Mentor Lifetime Product Replacement Policy



CONTENTS

MemoryGel™ Breast Implants, A More Evolved Implant.....	1
About MemoryGel™ Implants MemoryGel™ Implants Product Scale	
All Cohesive, All the Time™	2
Round Gel Breast Implants, Cohesive I™	3
SILTEX™ Round Breast Implants, Moderate Profile, Cohesive I™ SILTEX™ Round Breast Implants, Moderate Plus Profile, Cohesive I™ SILTEX™ Round Breast Implants, High Profile, Cohesive I™ SILTEX™ Round Breast Implants, Ultra High Profile, Cohesive I™ Smooth Round Breast Implants, Low Profile, Cohesive I™ Smooth Round Breast Implants, Moderate Profile, Cohesive I™ Smooth Round Breast Implants, Moderate Plus Profile, Cohesive I™ Smooth Round Breast Implants, High Profile, Cohesive I™ Smooth Round Breast Implants, Ultra High Profile, Cohesive I™	
Round Gel Breast Implants, Cohesive II™	7
SILTEX™ Round Breast Implants, Moderate Profile, Cohesive II™ SILTEX™ Round Breast Implants, Moderate Plus Profile, Cohesive II™ SILTEX™ Round Breast Implants, High Profile, Cohesive II™	
CPG™ Gel Breast Implants, Cohesive III™	9
SILTEX™ CPG™ Implants 331, Cohesive III™, Tall Height, Moderate Projection SILTEX™ CPG™ Implants 321, Cohesive III™, Medium Height, Moderate Projection SILTEX™ CPG™ Implants 311, Cohesive III™, Low Height, Moderate Projection SILTEX™ CPG™ Implants 332, Cohesive III™, Tall Height, Moderate Plus Projection SILTEX™ CPG™ Implants 322, Cohesive III™, Medium Height, Moderate Plus Projection SILTEX™ CPG™ Implants 312, Cohesive III™, Low Height, Moderate Plus Projection SILTEX™ CPG™ Implants 333, Cohesive III™, Tall Height, High Projection SILTEX™ CPG™ Implants 323, Cohesive III™, Medium Height, High Projection SILTEX™ CPG™ Implants 313, Cohesive III™, Low Height, High Projection SILTEX™ CONTOUR PROFILE™ Tissue Expanders / CPG™ Gel Breast Implants Sizing Guide – Two-Stage Breast Reconstruction	
BECKER™ Expander/Breast Implants.....	15
SILTEX™ Round BECKER™ 25 Expander/Breast Implants, Cohesive I™ SILTEX™ Round BECKER™ 50 Expander/Breast Implants, Cohesive I™ SILTEX™ CONTOUR PROFILE™ BECKER™ 35 Expander/Breast Implants, Cohesive II™	
SPECTRA™ Adjustable Gel Breast Implants.....	16
SILTEX™ Round SPECTRA™ Adjustable Gel Implants, Cohesive I™ Smooth Round SPECTRA™ Adjustable Gel Implants, Cohesive I™	
Sterile Resterilizable Gel Breast Implant Sizers	17
Round Breast Implant Sizers, Low Profile Round Breast Implant Sizers, Moderate Profile Round Breast Implant Sizers, Moderate Plus Profile Round Breast Implant Sizers, High Profile Round Breast Implant Sizers, Ultra High Profile	

CPG™ Gel Breast Implant Sizers	20
CPG™ Implant Sizers 331, Cohesive III™, Tall Height, Moderate Projection,	
CPG™ Implant Sizers 321, Cohesive III™, Medium Height, Moderate Projection	
CPG™ Implant Sizers 311, Cohesive III™, Low Height, Moderate Projection	
CPG™ Implant Sizers 332, Cohesive III™, Tall Height, Moderate Plus Projection	
CPG™ Implant Sizers 322, Cohesive III™, Medium Height, Moderate Plus Projection	
CPG™ Implant Sizers 312, Cohesive III™, Low Height, Moderate Plus Projection	
CPG™ Implant Sizers 333, Cohesive III™, Tall Height, High Projection	
CPG™ Implant Sizers 323, Cohesive III™, Medium Height, High Projection	
CPG™ Implant Sizers 313, Cohesive III™, Low Height, High Projection	
CONTOUR PROFILE™ Tissue Expanders	23
CPX2&CPX4 CONTOUR PROFILE™ Expander, Low Height, Styles 6100, 8100, 9100	
CPX2&CPX4 CONTOUR PROFILE™ Expander, Medium Height, Styles 6200, 8200, 9200	
CPX2&CPX4 CONTOUR PROFILE™ Expander, Tall Height, Styles 6300, 8300, 9300	
Other Tissue Expanders.....	27
Smooth Round Tissue Expanders	
Smooth Elliptical Tissue Expanders	
Smooth Crescent Tissue Expanders	
Smooth Rectangle Tissue Expanders	
Round Saline Breast Implants	29
SILTEX™ Round Breast Implants, Moderate Profile	
Smooth Round Breast Implants, Moderate Profile	
Smooth Round Breast Implants, Moderate Plus Profile	
Smooth Round Breast Implants, High Profile	
CONTOUR PROFILE™ Saline Breast Implants	30
SILTEX™ CONTOUR PROFILE™ Implant, Moderate Profile	
SILTEX™ CONTOUR PROFILE™ Implant, High Profile	
SPECTRUM™ Post-Operatively Adjustable Saline Breast Implants	31
Smooth Round SPECTRUM™ Implants	
SILTEX™ Round SPECTRUM™ Implants	
SILTEX™ CONTOUR PROFILE™ SPECTRUM™ Implants	
STERILE SALINE BREAST IMPLANT SIZERS	32
Round Breast Implant Sizers, Moderate Profile	
Round Breast Implant Sizers, Moderate Plus Profile	
Round Breast Implant Sizers, High Profile	
CONTOUR PROFILE™ Saline Breast Implant Sizers, High Profile	
Accessories	34
Injection Port Detector	
Injection Dome	
Important Safety Information.....	35
Contact Information	36

MemoryGel™

BREAST IMPLANTS

A More Evolved Implant

- Strict US and EU manufacturing standards
- Highly compliant shell for ease of placement
- Lifetime product replacement policy
- PatientSafe coverage limited warranty or PatientCare Promise limited warranty†
- Low, Moderate, Moderate Plus, High, and Ultra High projections
- Proprietary silicone gel formula for a natural touch that resembles breast tissue

About MemoryGel™ Breast Implants

MENTOR® MemoryGel™ Breast Implants feature a proprietary cohesive silicone gel formulation used to fill all MENTOR® Silicone Gel-Filled Breast Implants around the world. By varying the components of the gel, Mentor is able to produce a wide selection of products ranging from very soft to very firm.

MemoryGel™ Breast Implants Product Scale

Product Profile	Cohesive I™	Cohesive II™	Cohesive III™
Round Low	X		
Round Moderate Plus	X	X	
Round Moderate	X	X	
Round High	X	X	
Round Ultra High	X		
CPG™ Gel Breast Implant			X
Round BECKER™ 25 Expander/Breast Implant	X		
Round BECKER™ 50 Expander/Breast Implant	X		
CONTOUR PROFILE™ BECKER™ 35 Expander/Breast Implant		X	
SPECTRA™ Adjustable Gel Breast Implant	X		

† In case of eligibility, depending on the date of surgery, the implant will fall under one of the above warranties.

All Cohesive, All the Time.™



All MENTOR® Silicone Gel-Filled Breast Implants contain gel that is cohesive, safe and aesthetically pleasing.

Cohesive I™

The standard cohesive level gel used in MENTOR® Breast Implants. This is the softest gel and has been preferred for years in textured and smooth Round Low, Moderate, Moderate Plus, High, and Ultra High Profile Gel Breast Implants as well as the Round SPECTRA™ Adjustable Gel Breast Implants and BECKER™ Expander/Breast Implants.

Cohesive II™

A slightly firmer gel, for surgeons wanting a firmer feeling implant. This gel is used in textured Round Moderate, Moderate Plus, High Profile Gel Breast Implants and CONTOUR PROFILE™ BECKER™ Expander/Breast Implants.

Cohesive III™

Mentor's most cohesive gel, providing shape retention with a pleasing level of firmness for optimal aesthetic results. This gel is used in the MENTOR® CPG™ Gel Breast Implants.

Round Gel Breast Implants, Cohesive I™

SILTEX™ Round Breast Implants, Moderate Profile, Cohesive I™

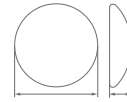

Volume	Diameter	Projection	Catalog #	Resterilizable Gel Sizer*
100 cc	8,8 cm	2,5 cm	354-1007	RSZ-7100
125 cc	9,3 cm	2,8 cm	354-1257	RSZ-7125
150 cc	10,2 cm	2,7 cm	354-1507	RSZ-7150
175 cc	10,7 cm	2,8 cm	354-1757	RSZ-7175
200 cc	11,2 cm	2,8 cm	354-2007	RSZ-7200
225 cc	11,4 cm	3,0 cm	354-2257	RSZ-7225
250 cc	11,5 cm	3,3 cm	354-2507	RSZ-7250
275 cc	12,4 cm	3,4 cm	354-2757	RSZ-7275
300 cc	12,6 cm	3,5 cm	354-3007	RSZ-7300
325 cc	12,9 cm	3,6 cm	354-3257	RSZ-7325
350 cc	13,4 cm	3,7 cm	354-3507	RSZ-7350
375 cc	13,4 cm	3,8 cm	354-3757	RSZ-7375
400 cc	13,5 cm	3,9 cm	354-4007	RSZ-7400
450 cc	13,9 cm	4,1 cm	354-4507	RSZ-7450
500 cc	14,2 cm	4,3 cm	354-5007	RSZ-7500
550 cc	14,8 cm	4,4 cm	354-5507	RSZ-7550
600 cc	15,4 cm	4,5 cm	354-6007	RSZ-7600
700 cc	16,8 cm	4,3 cm	354-7007	RSZ-7700
800 cc	17,2 cm	4,6 cm	354-8007	RSZ-7800

SILTEX™ Round Breast Implants, Moderate Plus Profile, Cohesive I™



Volume	Diameter	Projection	Catalog #	Resterilizable Gel Sizer*
100 cc	8,1 cm	2,7 cm	354-1001	RSZ-1001
125 cc	8,8 cm	2,9 cm	354-1251	RSZ-1251
150 cc	9,4 cm	3,0 cm	354-1501	RSZ-1501
175 cc	10,0 cm	3,2 cm	354-1751	RSZ-1751
200 cc	10,5 cm	3,3 cm	354-2001	RSZ-2001
225 cc	10,9 cm	3,5 cm	354-2251	RSZ-2251
250 cc	11,3 cm	3,6 cm	354-2501	RSZ-2501
275 cc	11,7 cm	3,7 cm	354-2751	RSZ-2751
300 cc	12,0 cm	3,7 cm	354-3001	RSZ-3001
325 cc	12,3 cm	3,8 cm	354-3251	RSZ-3251
350 cc	12,6 cm	3,8 cm	354-3501	RSZ-3501
375 cc	12,9 cm	3,9 cm	354-3751	RSZ-3751
400 cc	13,2 cm	4,0 cm	354-4001	RSZ-4001
450 cc	13,7 cm	4,1 cm	354-4501	RSZ-4501
500 cc	14,1 cm	4,2 cm	354-5001	RSZ-5001
550 cc	14,4 cm	4,4 cm	354-5501	RSZ-5501
600 cc	14,7 cm	4,5 cm	354-6001	RSZ-6001
700 cc	15,7 cm	4,8 cm	354-7001	RSZ-7001
800 cc	16,6 cm	5,0 cm	354-8001	RSZ-8001

*Resterilizable up to 10 times.

Note: Individual implant dimensions may vary slightly in products of this type.

Not all units will conform exactly to the dimensions noted above

Round Gel Breast Implants, Cohesive I™ CONT'D

SILTEX™ Round Breast Implants, High Profile, Cohesive I™

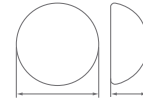

Volume	Diameter	Projection	Catalog #	Resterilizable Gel Sizer*
125 cc	8,4 cm	3,6 cm	354-4125	RSZ-1254
150 cc	8,9 cm	3,8 cm	354-4150	RSZ-1504
175 cc	9,4 cm	4,0 cm	354-4175	RSZ-1754
200 cc	9,9 cm	4,1 cm	354-4200	RSZ-2004
225 cc	10,2 cm	4,3 cm	354-4225	RSZ-2254
250 cc	10,5 cm	4,5 cm	354-4250	RSZ-2504
275 cc	10,9 cm	4,6 cm	354-4275	RSZ-2754
300 cc	11,1 cm	4,7 cm	354-4300	RSZ-3004
325 cc	11,5 cm	4,8 cm	354-4325	RSZ-3254
350 cc	11,7 cm	4,9 cm	354-4350	RSZ-3504
375 cc	12,0 cm	5,0 cm	354-4375	RSZ-3754
400 cc	12,3 cm	5,1 cm	354-4400	RSZ-4004
425 cc	12,5 cm	5,2 cm	354-4425	RSZ-4254
450 cc	12,7 cm	5,2 cm	354-4450	RSZ-4504
500 cc	13,2 cm	5,4 cm	354-4500	RSZ-5004
550 cc	13,5 cm	5,6 cm	354-4550	RSZ-5504
600 cc	14,0 cm	5,7 cm	354-4600	RSZ-6004
650 cc	14,3 cm	5,8 cm	354-4650	RSZ-6504
700 cc	14,7 cm	6,0 cm	354-4700	RSZ-7004
800 cc	15,4 cm	6,3 cm	354-4800	RSZ-8004

SILTEX™ Round Breast Implants, Ultra High Profile, Cohesive I™

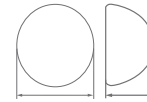

Volume	Diameter	Projection	Catalog #	Resterilizable Gel Sizer*
135 cc	8,0 cm	4,3 cm	354-5135	RSZ-5135
160 cc	8,4 cm	4,5 cm	354-5160	RSZ-5160
185 cc	8,6 cm	4,6 cm	354-5185	RSZ-5185
215 cc	8,9 cm	4,7 cm	354-5215	RSZ-5215
240 cc	9,2 cm	4,9 cm	354-5240	RSZ-5240
270 cc	9,5 cm	5,0 cm	354-5270	RSZ-5270
295 cc	9,9 cm	5,2 cm	354-5295	RSZ-5295
320 cc	10,0 cm	5,3 cm	354-5320	RSZ-5320
350 cc	10,3 cm	5,4 cm	354-5350	RSZ-5350
375 cc	10,5 cm	5,5 cm	354-5375	RSZ-5375
400 cc	10,8 cm	5,6 cm	354-5400	RSZ-5400
430 cc	11,1 cm	5,8 cm	354-5430	RSZ-5430
455 cc	11,3 cm	5,9 cm	354-5455	RSZ-5455
480 cc	11,6 cm	6,0 cm	354-5480	RSZ-5480
535 cc	12,1 cm	6,3 cm	354-5535	RSZ-5535
590 cc	12,6 cm	6,5 cm	354-5590	RSZ-5590

*Resterilizable up to 10 times.

Round Gel Breast Implants, Cohesive I™ CONT'D

Smooth Round Breast Implants, Low Profile, Cohesive I™

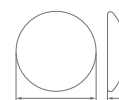

Volume	Diameter	Projection	Catalog #	Resterilizable Gel Sizer*
100 cc	9,4 cm	1,9 cm	310JSP1100	RSZ-1100
125 cc	10,1 cm	2,0 cm	310JSP1125	RSZ-1125
150 cc	10,7 cm	2,2 cm	310JSP1150	RSZ-1150
175 cc	11,3 cm	2,3 cm	310JSP1175	RSZ-1175
200 cc	11,8 cm	2,4 cm	310JSP1200	RSZ-1200
225 cc	12,3 cm	2,5 cm	310JSP1225	RSZ-1225
250 cc	12,7 cm	2,6 cm	310JSP1250	RSZ-1250
275 cc	13,1 cm	2,7 cm	310JSP1275	RSZ-1275
300 cc	13,5 cm	2,7 cm	310JSP1300	RSZ-1300
325 cc	13,9 cm	2,8 cm	310JSP1325	RSZ-1325
350 cc	14,2 cm	2,9 cm	310JSP1350	RSZ-1350
375 cc	14,5 cm	2,9 cm	310JSP1375	RSZ-1375
400 cc	14,8 cm	3,0 cm	310JSP1400	RSZ-1400
450 cc	15,4 cm	3,1 cm	310JSP1450	RSZ-1450
500 cc	16,0 cm	3,3 cm	310JSP1500	RSZ-1500
550 cc	16,5 cm	3,4 cm	310JSP1550	RSZ-1550
600 cc	17,0 cm	3,5 cm	310JSP1600	RSZ-1600

Smooth Round Breast Implants, Moderate Profile, Cohesive I™

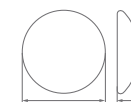

Volume	Diameter	Projection	Catalog #	Resterilizable Gel Sizer*
100 cc	9,3 cm	2,1 cm	350-7100 BC	RSZ-7100
125 cc	10,0 cm	2,2 cm	350-7125 BC	RSZ-7125
150 cc	10,3 cm	2,3 cm	350-7150 BC	RSZ-7150
175 cc	11,2 cm	2,4 cm	350-7175 BC	RSZ-7175
200 cc	11,7 cm	2,5 cm	350-7200 BC	RSZ-7200
225 cc	12,2 cm	2,6 cm	350-7225 BC	RSZ-7225
250 cc	12,3 cm	2,8 cm	350-7250 BC	RSZ-7250
275 cc	13,2 cm	2,9 cm	350-7275 BC	RSZ-7275
300 cc	13,5 cm	3,0 cm	350-7300 BC	RSZ-7300
325 cc	13,9 cm	3,0 cm	350-7325 BC	RSZ-7325
350 cc	14,2 cm	3,1 cm	350-7350 BC	RSZ-7350
375 cc	14,4 cm	3,2 cm	350-7375 BC	RSZ-7375
400 cc	14,5 cm	3,2 cm	350-7400 BC	RSZ-7400
450 cc	14,9 cm	3,4 cm	350-7450 BC	RSZ-7450
500 cc	15,2 cm	3,6 cm	350-7500 BC	RSZ-7500
550 cc	15,9 cm	3,6 cm	350-7550 BC	RSZ-7550
600 cc	16,5 cm	3,7 cm	350-7600 BC	RSZ-7600
700 cc	17,4 cm	3,9 cm	350-7700 BC	RSZ-7700
800 cc	18,2 cm	4,1 cm	350-7800 BC	RSZ-7800

*Resterilizable up to 10 times.

Note: Individual implant dimensions may vary slightly in products of this type.

Not all units will conform exactly to the dimensions noted above

Round Gel Breast Implants, Cohesive I™ CONT'D

Smooth Round Breast Implants, Moderate Plus Profile, Cohesive I™

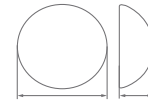

Volume	Diameter	Projection	Catalog #	Resterilizable Gel Sizer*
100 cc	8,2 cm	2,7 cm	350-1001 BC	RSZ-1001
125 cc	8,9 cm	2,8 cm	350-1251 BC	RSZ-1251
150 cc	9,5 cm	2,9 cm	350-1501 BC	RSZ-1501
175 cc	10,0 cm	3,1 cm	350-1751 BC	RSZ-1751
200 cc	10,5 cm	3,2 cm	350-2001 BC	RSZ-2001
225 cc	10,9 cm	3,3 cm	350-2251 BC	RSZ-2251
250 cc	11,3 cm	3,4 cm	350-2501 BC	RSZ-2501
275 cc	11,7 cm	3,5 cm	350-2751 BC	RSZ-2751
300 cc	12,0 cm	3,6 cm	350-3001 BC	RSZ-3001
325 cc	12,3 cm	3,8 cm	350-3251 BC	RSZ-3251
350 cc	12,5 cm	3,9 cm	350-3501 BC	RSZ-3501
375 cc	12,8 cm	4,0 cm	350-3751 BC	RSZ-3751
400 cc	13,1 cm	4,0 cm	350-4001 BC	RSZ-4001
450 cc	13,6 cm	4,2 cm	350-4501 BC	RSZ-4501
500 cc	14,1 cm	4,3 cm	350-5001 BC	RSZ-5001
550 cc	14,6 cm	4,5 cm	350-5501 BC	RSZ-5501
600 cc	15,0 cm	4,6 cm	350-6001 BC	RSZ-6001
700 cc	15,8 cm	4,9 cm	350-7001 BC	RSZ-7001
800 cc	16,5 cm	5,1 cm	350-8001 BC	RSZ-8001

Smooth Round Breast Implants, High Profile, Cohesive I™

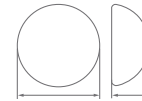

Volume	Diameter	Projection	Catalog #	Resterilizable Gel Sizer*
125 cc	8,3 cm	3,5 cm	350-1254 BC	RSZ-1254
150 cc	8,8 cm	3,7 cm	350-1504 BC	RSZ-1504
175 cc	9,3 cm	3,9 cm	350-1754 BC	RSZ-1754
200 cc	9,7 cm	4,0 cm	350-2004 BC	RSZ-2004
225 cc	10,1 cm	4,2 cm	350-2254 BC	RSZ-2254
250 cc	10,5 cm	4,3 cm	350-2504 BC	RSZ-2504
275 cc	10,8 cm	4,4 cm	350-2754 BC	RSZ-2754
300 cc	11,1 cm	4,5 cm	350-3004 BC	RSZ-3004
325 cc	11,4 cm	4,6 cm	350-3254 BC	RSZ-3254
350 cc	11,7 cm	4,8 cm	350-3504 BC	RSZ-3504
375 cc	12,0 cm	4,8 cm	350-3754 BC	RSZ-3754
400 cc	12,2 cm	5,0 cm	350-4004 BC	RSZ-4004
425 cc	12,5 cm	5,0 cm	350-4254 BC	RSZ-4254
450 cc	12,8 cm	5,1 cm	350-4504 BC	RSZ-4504
500 cc	13,2 cm	5,3 cm	350-5004 BC	RSZ-5004
550 cc	13,6 cm	5,5 cm	350-5504 BC	RSZ-5504
600 cc	14,0 cm	5,6 cm	350-6004 BC	RSZ-6004
650 cc	14,4 cm	5,7 cm	350-6504 BC	RSZ-6504
700 cc	14,8 cm	5,8 cm	350-7004 BC	RSZ-7004
800 cc	15,5 cm	6,0 cm	350-8004 BC	RSZ-8004

*Resterilizable up to 10 times.

Round Gel Breast Implants, Cohesive I™ CONT'D

Smooth Round Breast Implants, Ultra High Profile, Cohesive I™

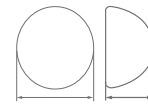

Volume	Diameter	Projection	Catalog #	Restorable Gel Sizer*
135 cc	7,8 cm	4,1 cm	350-5135 BC	RSZ-5135
160 cc	8,2 cm	4,3 cm	350-5160 BC	RSZ-5160
185 cc	8,4 cm	4,4 cm	350-5185 BC	RSZ-5185
215 cc	8,7 cm	4,5 cm	350-5215 BC	RSZ-5215
240 cc	9,0 cm	4,7 cm	350-5240 BC	RSZ-5240
270 cc	9,3 cm	4,8 cm	350-5270 BC	RSZ-5270
295 cc	9,7 cm	5,0 cm	350-5295 BC	RSZ-5295
320 cc	9,8 cm	5,1 cm	350-5320 BC	RSZ-5320
350 cc	10,1 cm	5,2 cm	350-5350 BC	RSZ-5350
375 cc	10,4 cm	5,3 cm	350-5375 BC	RSZ-5375
400 cc	10,6 cm	5,4 cm	350-5400 BC	RSZ-5400
430 cc	10,9 cm	5,6 cm	350-5430 BC	RSZ-5430
455 cc	11,2 cm	5,7 cm	350-5455 BC	RSZ-5455
480 cc	11,4 cm	5,8 cm	350-5480 BC	RSZ-5480
535 cc	12,0 cm	6,1 cm	350-5535 BC	RSZ-5535
590 cc	12,5 cm	6,3 cm	350-5590 BC	RSZ-5590

Round Gel Breast Implants, Cohesive II™

SILTEX™ Round Breast Implants, Moderate Profile, Cohesive II™

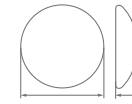

Volume	Diameter	Projection	Catalog #	Restorable Gel Sizer*
100 cc	9,1 cm	2,6 cm	354-1009	RSZ-7100
125 cc	9,3 cm	2,8 cm	354-1259	RSZ-7125
150 cc	10,1 cm	2,4 cm	354-1509	RSZ-7150
175 cc	10,5 cm	2,9 cm	354-1759	RSZ-7175
200 cc	11,2 cm	2,8 cm	354-2009	RSZ-7200
225 cc	11,5 cm	3,0 cm	354-2259	RSZ-7225
250 cc	11,6 cm	3,5 cm	354-2509	RSZ-7250
275 cc	12,6 cm	3,1 cm	354-2759	RSZ-7275
300 cc	12,6 cm	3,6 cm	354-3009	RSZ-7300
325 cc	13,1 cm	3,6 cm	354-3259	RSZ-7325
350 cc	13,4 cm	3,5 cm	354-3509	RSZ-7350
375 cc	13,4 cm	3,9 cm	354-3759	RSZ-7375
400 cc	13,7 cm	3,8 cm	354-4009	RSZ-7400
450 cc	13,7 cm	4,6 cm	354-4509	RSZ-7450
500 cc	14,2 cm	4,8 cm	354-5009	RSZ-7500
550 cc	14,5 cm	4,5 cm	354-5509	RSZ-7550
600 cc	15,3 cm	4,6 cm	354-6009	RSZ-7600
700 cc	16,3 cm	5,0 cm	354-7009	RSZ-7700
800 cc	16,7 cm	5,4 cm	354-8009	RSZ-7800

*Restorable up to 10 times.

Note: Individual implant dimensions may vary slightly in products of this type.

Not all units will conform exactly to the dimensions noted above

Round Gel Breast Implants, Cohesive II™ CONT'D

SILTEX™ Round Breast Implants, Moderate Plus Profile, Cohesive II™

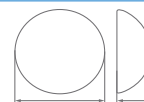

Volume	Diameter	Projection	Catalog #	Resterilizable Gel Sizer*
100 cc	8,1 cm	2,7 cm	324-5100	RSZ-1001
125 cc	8,8 cm	2,9 cm	324-5125	RSZ-1251
150 cc	9,4 cm	3,0 cm	324-5150	RSZ-1501
175 cc	10,0 cm	3,2 cm	324-5175	RSZ-1751
200 cc	10,5 cm	3,3 cm	324-5200	RSZ-2001
225 cc	10,9 cm	3,5 cm	324-5225	RSZ-2251
250 cc	11,3 cm	3,6 cm	324-5250	RSZ-2501
275 cc	11,7 cm	3,7 cm	324-5275	RSZ-2751
300 cc	12,0 cm	3,7 cm	324-5300	RSZ-3001
325 cc	12,3 cm	3,8 cm	324-5325	RSZ-3251
350 cc	12,6 cm	3,8 cm	324-5350	RSZ-3501
375 cc	12,9 cm	3,9 cm	324-5375	RSZ-3751
400 cc	13,2 cm	4,0 cm	324-5400	RSZ-4001
450 cc	13,7 cm	4,1 cm	324-5450	RSZ-4501
500 cc	14,1 cm	4,2 cm	324-5500	RSZ-5001
550 cc	14,4 cm	4,4 cm	324-5550	RSZ-5501
600 cc	14,7 cm	4,5 cm	324-5600	RSZ-6001
700 cc	15,7 cm	4,8 cm	324-5700	RSZ-7001
800 cc	16,6 cm	5,0 cm	324-5800	RSZ-8001

SILTEX™ Round Breast Implants, High Profile, Cohesive II™



Volume	Diameter	Projection	Catalog #	Resterilizable Gel Sizer*
125 cc	8,4 cm	3,6 cm	324-4125	RSZ-1254
150 cc	8,9 cm	3,8 cm	324-4150	RSZ-1504
175 cc	9,4 cm	4,0 cm	324-4175	RSZ-1754
200 cc	9,9 cm	4,1 cm	324-4200	RSZ-2004
225 cc	10,2 cm	4,3 cm	324-4225	RSZ-2254
250 cc	10,5 cm	4,5 cm	324-4250	RSZ-2504
275 cc	10,9 cm	4,6 cm	324-4275	RSZ-2754
300 cc	11,1 cm	4,7 cm	324-4300	RSZ-3004
325 cc	11,5 cm	4,8 cm	324-4325	RSZ-3254
350 cc	11,7 cm	4,9 cm	324-4350	RSZ-3504
375 cc	12,0 cm	5,0 cm	324-4375	RSZ-3754
400 cc	12,3 cm	5,1 cm	324-4400	RSZ-4004
425 cc	12,5 cm	5,2 cm	324-4425	RSZ-4254
450 cc	12,7 cm	5,2 cm	324-4450	RSZ-4504
500 cc	13,2 cm	5,4 cm	324-4500	RSZ-5004
550 cc	13,5 cm	5,6 cm	324-4550	RSZ-5504
600 cc	14,0 cm	5,7 cm	324-4600	RSZ-6004
650 cc	14,3 cm	5,8 cm	324-4650	RSZ-6504
700 cc	14,7 cm	6,0 cm	324-4700	RSZ-7004
800 cc	15,4 cm	6,3 cm	324-4800	RSZ-8004

*Resterilizable up to 10 times.

CPG™ Gel Breast Implants, Cohesive III™

CPG™ BREAST IMPLANT NAMING LEGEND		
Cohesive Level	Implant Height	Implant Projection
III 3	Tall 3	High 3
	Medium 2	Moderate Plus 2
	Low 1	Moderate 1

KEY: DIGIT 1 = COHESIVE LEVEL
 DIGIT 2 = HEIGHT OF IMPLANT
 DIGIT 3 = PROJECTION OF IMPLANT

UNDERSTANDING THE “A” AND ARC LENGTH MEASUREMENTS

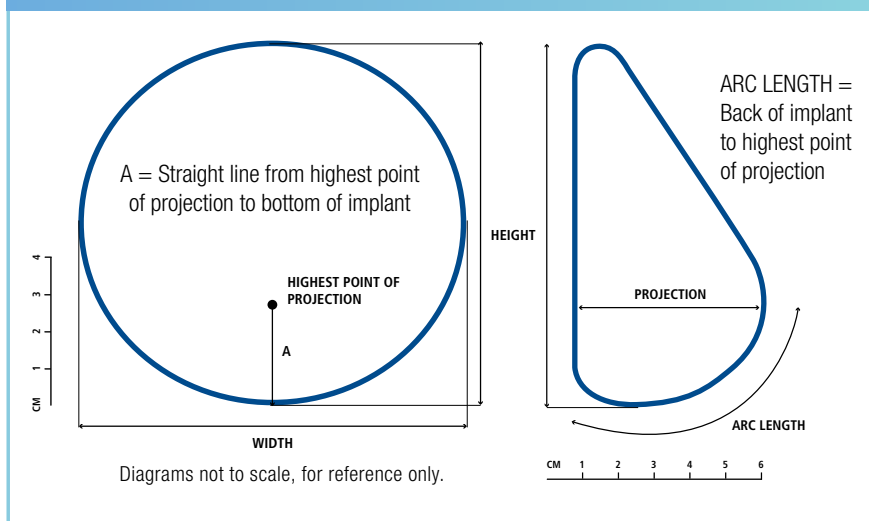

CPG™ Gel Breast Implants, Cohesive III™ CONT'D

CPG™ Implants 331, Cohesive III™, Tall Height, Moderate Projection



Volume	Width	Height	Projection	A	Arc Length	Catalog #	Resterilizable Gel Sizer*
125 cc	9,0 cm	9,2 cm	3,2 cm	2,4 cm	3,9 cm	334-0903	RSZ-0903
150 cc	9,5 cm	9,7 cm	3,3 cm	2,6 cm	4,1 cm	334-0953	RSZ-0953
175 cc	10,0 cm	10,2 cm	3,4 cm	2,7 cm	4,3 cm	334-1003	RSZ-1003
200 cc	10,5 cm	10,7 cm	3,5 cm	2,8 cm	4,6 cm	334-1053	RSZ-1053
230 cc	11,0 cm	11,3 cm	3,6 cm	3,0 cm	4,8 cm	334-1103	RSZ-1103
265 cc	11,5 cm	11,8 cm	3,7 cm	3,1 cm	5,0 cm	334-1153	RSZ-1153
300 cc	12,0 cm	12,3 cm	3,9 cm	3,2 cm	5,2 cm	334-1203	RSZ-1203
340 cc	12,5 cm	12,8 cm	4,0 cm	3,4 cm	5,4 cm	334-1253	RSZ-1253
380 cc	13,0 cm	13,3 cm	4,1 cm	3,5 cm	5,6 cm	334-1303	RSZ-1303
425 cc	13,5 cm	13,8 cm	4,3 cm	3,6 cm	5,9 cm	334-1353	RSZ-1353
475 cc	14,0 cm	14,3 cm	4,5 cm	3,8 cm	6,1 cm	334-1403	RSZ-1403
530 cc	14,5 cm	14,8 cm	4,6 cm	3,9 cm	6,3 cm	334-1453	RSZ-1453
585 cc	15,0 cm	15,3 cm	4,8 cm	4,0 cm	6,5 cm	334-1503	RSZ-1503
645 cc	15,5 cm	15,9 cm	5,0 cm	4,2 cm	6,7 cm	334-1553	RSZ-1553

CPG™ Implants 321, Cohesive III™, Medium Height, Moderate Projection

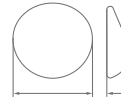

Volume	Width	Height	Projection	A	Arc Length	Catalog #	Resterilizable Gel Sizer*
120 cc	9,0 cm	8,5 cm	3,3 cm	3,1 cm	4,3 cm	354-0908	RSZ-0908
135 cc	9,5 cm	8,9 cm	3,5 cm	3,2 cm	4,5 cm	354-0958	RSZ-0958
155 cc	10,0 cm	9,4 cm	3,7 cm	3,4 cm	4,7 cm	354-1008	RSZ-1008
180 cc	10,5 cm	9,9 cm	3,8 cm	3,6 cm	5,0 cm	354-1058	RSZ-1058
215 cc	11,0 cm	10,3 cm	3,9 cm	3,6 cm	5,1 cm	354-1108	RSZ-1108
245 cc	11,5 cm	10,8 cm	4,0 cm	3,8 cm	5,3 cm	354-1158	RSZ-1158
280 cc	12,0 cm	11,3 cm	4,2 cm	4,0 cm	5,6 cm	354-1208	RSZ-1208
315 cc	12,5 cm	11,8 cm	4,4 cm	4,1 cm	5,8 cm	354-1258	RSZ-1258
355 cc	13,0 cm	12,2 cm	4,6 cm	4,3 cm	6,0 cm	354-1308	RSZ-1308
395 cc	13,5 cm	12,7 cm	4,7 cm	4,5 cm	6,3 cm	354-1358	RSZ-1358
440 cc	14,0 cm	13,2 cm	4,9 cm	4,6 cm	6,5 cm	354-1408	RSZ-1408
480 cc	14,5 cm	13,6 cm	5,0 cm	5,0 cm	6,9 cm	354-1458	RSZ-1458
530 cc	15,0 cm	14,1 cm	5,2 cm	5,1 cm	7,2 cm	354-1508	RSZ-1508
640 cc	16,0 cm	15,0 cm	5,6 cm	5,5 cm	7,6 cm	354-1608	RSZ-1608
775 cc	17,0 cm	16,0 cm	5,9 cm	5,8 cm	8,1 cm	354-1708	RSZ-1708

CPG™ Implants 311, Cohesive III™, Low Height, Moderate Projection

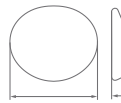

Volume	Width	Height	Projection	A	Arc Length	Catalog #	Resterilizable Gel Sizer*
100 cc	9,0 cm	8,0 cm	3,0 cm	2,5 cm	4,1 cm	334-0901	RSZ-0090
120 cc	9,5 cm	8,5 cm	3,2 cm	2,6 cm	4,3 cm	334-0951	RSZ-0095
140 cc	10,0 cm	8,9 cm	3,4 cm	2,8 cm	4,5 cm	334-1001	RSZ-0100
160 cc	10,5 cm	9,4 cm	3,6 cm	2,9 cm	4,7 cm	334-1051	RSZ-0105
180 cc	11,0 cm	9,8 cm	3,7 cm	3,0 cm	5,0 cm	334-1101	RSZ-0110
210 cc	11,5 cm	10,3 cm	3,9 cm	3,2 cm	5,2 cm	334-1151	RSZ-0115
235 cc	12,0 cm	10,7 cm	4,1 cm	3,3 cm	5,4 cm	334-1201	RSZ-0120
270 cc	12,5 cm	11,2 cm	4,2 cm	3,5 cm	5,6 cm	334-1251	RSZ-0125
300 cc	13,0 cm	11,6 cm	4,4 cm	3,6 cm	5,9 cm	334-1301	RSZ-0130
335 cc	13,5 cm	12,0 cm	4,6 cm	3,7 cm	6,1 cm	334-1351	RSZ-0135
375 cc	14,0 cm	12,5 cm	4,7 cm	3,9 cm	6,3 cm	334-1401	RSZ-0140
415 cc	14,5 cm	12,9 cm	4,9 cm	4,0 cm	6,5 cm	334-1451	RSZ-0145
460 cc	15,0 cm	13,4 cm	5,1 cm	4,1 cm	6,8 cm	334-1501	RSZ-0150
510 cc	15,5 cm	13,8 cm	5,2 cm	4,3 cm	7,0 cm	334-1551	RSZ-0155
560 cc	16,0 cm	14,3 cm	5,4 cm	4,4 cm	7,2 cm	334-1601	RSZ-0160
615 cc	16,5 cm	14,7 cm	5,6 cm	4,6 cm	7,4 cm	334-1651	RSZ-0165

*Resterilizable up to 10 times.

Note: Individual implant dimensions may vary slightly in products of this type.

Not all units will conform exactly to the dimensions noted above

CPG™ Gel Breast Implants, Cohesive III™ CONT'D

CPG™ Implants 332, Cohesive III™, Tall Height, Moderate Plus Projection



Volume	Width	Height	Projection	A	Arc Length	Catalog #	Resterilizable Gel Sizer*
145 cc	9,0 cm	9,4 cm	3,8 cm	2,8 cm	4,6 cm	334-0909	RSZ-0909
175 cc	9,5 cm	9,9 cm	4,0 cm	3,0 cm	4,9 cm	334-0959	RSZ-0959
205 cc	10,0 cm	10,4 cm	4,2 cm	3,1 cm	5,1 cm	334-1009	RSZ-1009
235 cc	10,5 cm	10,9 cm	4,4 cm	3,3 cm	5,4 cm	334-1059	RSZ-1059
270 cc	11,0 cm	11,5 cm	4,7 cm	3,5 cm	5,7 cm	334-1109	RSZ-1109
305 cc	11,5 cm	12,0 cm	4,9 cm	3,6 cm	5,9 cm	334-1159	RSZ-1159
350 cc	12,0 cm	12,5 cm	5,1 cm	3,8 cm	6,2 cm	334-1209	RSZ-1209
395 cc	12,5 cm	13,0 cm	5,3 cm	3,9 cm	6,4 cm	334-1259	RSZ-1259
445 cc	13,0 cm	13,5 cm	5,5 cm	4,1 cm	6,7 cm	334-1309	RSZ-1309
495 cc	13,5 cm	14,1 cm	5,7 cm	4,2 cm	7,0 cm	334-1359	RSZ-1359
555 cc	14,0 cm	14,6 cm	5,9 cm	4,4 cm	7,2 cm	334-1409	RSZ-1409
615 cc	14,5 cm	15,1 cm	6,1 cm	4,6 cm	7,5 cm	334-1459	RSZ-1459
680 cc	15,0 cm	15,6 cm	6,3 cm	4,7 cm	7,7 cm	334-1509	RSZ-1509

CPG™ Implants 322, Cohesive III™, Medium Height, Moderate Plus Projection

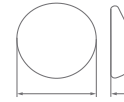

Volume	Width	Height	Projection	A	Arc Length	Catalog #	Resterilizable Gel Sizer*
140 cc	9,0 cm	8,5 cm	3,8 cm	2,9 cm	4,7 cm	334-0905	RSZ-0905
165 cc	9,5 cm	8,9 cm	4,0 cm	3,0 cm	4,9 cm	334-0955	RSZ-0955
195 cc	10,0 cm	9,4 cm	4,2 cm	3,2 cm	5,2 cm	334-1005	RSZ-1005
225 cc	10,5 cm	9,9 cm	4,4 cm	3,3 cm	5,5 cm	334-1055	RSZ-1055
255 cc	11,0 cm	10,3 cm	4,7 cm	3,5 cm	5,7 cm	334-1105	RSZ-1105
295 cc	11,5 cm	10,8 cm	4,9 cm	3,7 cm	6,0 cm	334-1155	RSZ-1155
330 cc	12,0 cm	11,3 cm	5,1 cm	3,8 cm	6,3 cm	334-1205	RSZ-1205
375 cc	12,5 cm	11,8 cm	5,3 cm	4,0 cm	6,5 cm	334-1255	RSZ-1255
420 cc	13,0 cm	12,2 cm	5,5 cm	4,1 cm	6,8 cm	334-1305	RSZ-1305
475 cc	13,5 cm	12,7 cm	5,7 cm	4,3 cm	7,0 cm	334-1355	RSZ-1355
525 cc	14,0 cm	13,2 cm	5,9 cm	4,5 cm	7,3 cm	334-1405	RSZ-1405
585 cc	14,5 cm	13,6 cm	6,1 cm	4,6 cm	7,6 cm	334-1455	RSZ-1455
650 cc	15,0 cm	14,1 cm	6,3 cm	4,8 cm	7,8 cm	334-1505	RSZ-1505

CPG™ Implants 312, Cohesive III™, Low Height, Moderate Plus Projection

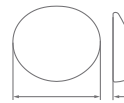

Volume	Width	Height	Projection	A	Arc Length	Catalog #	Resterilizable Gel Sizer*
125 cc	9,0 cm	8,0 cm	3,8 cm	2,5 cm	4,6 cm	334-0907	RSZ-0907
145 cc	9,5 cm	8,4 cm	4,0 cm	2,6 cm	4,8 cm	334-0957	RSZ-0957
170 cc	10,0 cm	8,8 cm	4,2 cm	2,7 cm	5,1 cm	334-1007	RSZ-1007
195 cc	10,5 cm	9,3 cm	4,4 cm	2,9 cm	5,4 cm	334-1057	RSZ-1057
225 cc	11,0 cm	9,7 cm	4,7 cm	3,0 cm	5,6 cm	334-1107	RSZ-1107
255 cc	11,5 cm	10,2 cm	4,9 cm	3,1 cm	5,9 cm	334-1157	RSZ-1157
290 cc	12,0 cm	10,6 cm	5,1 cm	3,3 cm	6,1 cm	334-1207	RSZ-1207
330 cc	12,5 cm	11,1 cm	5,3 cm	3,4 cm	6,4 cm	334-1257	RSZ-1257
370 cc	13,0 cm	11,5 cm	5,5 cm	3,6 cm	6,6 cm	334-1307	RSZ-1307
415 cc	13,5 cm	12,0 cm	5,7 cm	3,7 cm	6,9 cm	334-1357	RSZ-1357
465 cc	14,0 cm	12,4 cm	5,9 cm	3,8 cm	7,1 cm	334-1407	RSZ-1407
515 cc	14,5 cm	12,8 cm	6,1 cm	4,0 cm	7,4 cm	334-1457	RSZ-1457
570 cc	15,0 cm	13,3 cm	6,3 cm	4,1 cm	7,7 cm	334-1507	RSZ-1507
690 cc	16,0 cm	14,2 cm	6,8 cm	4,4 cm	8,2 cm	334-1607	RSZ-1607

*Resterilizable up to 10 times.

Note: Individual implant dimensions may vary slightly in products of this type.

Not all units will conform exactly to the dimensions noted above

CPG™ Gel Breast Implants, Cohesive III™ CONT'D

CPG™ Implants 333, Cohesive III™, Tall Height, High Projection



Volume	Width	Height	Projection	A	Arc Length	Catalog #	Resterilizable Gel Sizer*
180 cc	9,0 cm	9,4 cm	4,6 cm	3,1 cm	5,5 cm	334-0904	RSZ-4090
215 cc	9,5 cm	9,9 cm	4,8 cm	3,3 cm	5,8 cm	334-0954	RSZ-4095
250 cc	10,0 cm	10,4 cm	5,1 cm	3,4 cm	6,1 cm	334-1004	RSZ-4100
290 cc	10,5 cm	10,9 cm	5,3 cm	3,6 cm	6,4 cm	334-1054	RSZ-4105
330 cc	11,0 cm	11,5 cm	5,6 cm	3,8 cm	6,8 cm	334-1104	RSZ-4110
380 cc	11,5 cm	12,0 cm	5,8 cm	3,9 cm	7,1 cm	334-1154	RSZ-4115
430 cc	12,0 cm	12,5 cm	6,0 cm	4,1 cm	7,4 cm	334-1204	RSZ-4120
485 cc	12,5 cm	13,0 cm	6,2 cm	4,3 cm	7,7 cm	334-1254	RSZ-4125
545 cc	13,0 cm	13,5 cm	6,5 cm	4,5 cm	8,0 cm	334-1304	RSZ-4130
610 cc	13,5 cm	14,1 cm	6,7 cm	4,6 cm	8,3 cm	334-1354	RSZ-4135
680 cc	14,0 cm	14,6 cm	6,9 cm	4,8 cm	8,6 cm	334-1404	RSZ-4140
755 cc	14,5 cm	15,1 cm	7,1 cm	5,0 cm	8,9 cm	334-1454	RSZ-4145

CPG™ Implants 323, Cohesive III™, Medium Height, High Projection



Volume	Width	Height	Projection	A	Arc Length	Catalog #	Resterilizable Gel Sizer*
165 cc	9,0 cm	8,5 cm	4,6 cm	3,0 cm	5,3 cm	334-0902	RSZ-0902
195 cc	9,5 cm	8,9 cm	4,8 cm	3,2 cm	5,6 cm	334-0952	RSZ-0952
225 cc	10,0 cm	9,4 cm	5,1 cm	3,4 cm	5,9 cm	334-1002	RSZ-1002
260 cc	10,5 cm	9,9 cm	5,3 cm	3,5 cm	6,2 cm	334-1052	RSZ-1052
300 cc	11,0 cm	10,3 cm	5,6 cm	3,7 cm	6,5 cm	334-1102	RSZ-1102
345 cc	11,5 cm	10,8 cm	5,8 cm	3,9 cm	6,8 cm	334-1152	RSZ-1152
390 cc	12,0 cm	11,3 cm	6,0 cm	4,0 cm	7,1 cm	334-1202	RSZ-1202
440 cc	12,5 cm	11,8 cm	6,2 cm	4,2 cm	7,4 cm	334-1252	RSZ-1252
495 cc	13,0 cm	12,2 cm	6,5 cm	4,4 cm	7,7 cm	334-1302	RSZ-1302
555 cc	13,5 cm	12,7 cm	6,7 cm	4,5 cm	8,0 cm	334-1352	RSZ-1352
620 cc	14,0 cm	13,2 cm	6,9 cm	4,7 cm	8,3 cm	334-1402	RSZ-1402
685 cc	14,5 cm	13,6 cm	7,1 cm	4,9 cm	8,6 cm	334-1452	RSZ-1452

CPG™ Implants 313, Cohesive III™, Low Height, High Projection



Volume	Width	Height	Projection	A	Arc Length	Catalog #	Resterilizable Gel Sizer*
130 cc	9,0 cm	8,1 cm	4,4 cm	2,6 cm	5,2 cm	334-0906	RSZ-0906
155 cc	9,5 cm	8,6 cm	4,5 cm	2,7 cm	5,4 cm	334-0956	RSZ-0956
180 cc	10,0 cm	9,0 cm	4,6 cm	2,9 cm	5,7 cm	334-1006	RSZ-1006
210 cc	10,5 cm	9,5 cm	4,8 cm	3,0 cm	6,0 cm	334-1056	RSZ-1056
240 cc	11,0 cm	9,9 cm	4,9 cm	3,2 cm	6,3 cm	334-1106	RSZ-1106
270 cc	11,5 cm	10,3 cm	5,0 cm	3,3 cm	6,6 cm	334-1156	RSZ-1156
310 cc	12,0 cm	10,8 cm	5,2 cm	3,5 cm	6,9 cm	334-1206	RSZ-1206
350 cc	12,5 cm	11,2 cm	5,4 cm	3,6 cm	7,2 cm	334-1256	RSZ-1256
395 cc	13,0 cm	11,7 cm	5,6 cm	3,8 cm	7,4 cm	334-1306	RSZ-1306
440 cc	13,5 cm	12,2 cm	5,8 cm	3,9 cm	7,7 cm	334-1356	RSZ-1356
490 cc	14,0 cm	12,6 cm	6,1 cm	4,0 cm	8,0 cm	334-1406	RSZ-1406
545 cc	14,5 cm	13,1 cm	6,3 cm	4,2 cm	8,3 cm	334-1456	RSZ-1456
605 cc	15,0 cm	13,5 cm	6,6 cm	4,3 cm	8,6 cm	334-1506	RSZ-1506

*Resterilizable up to 10 times.

MEMORYGEL™ BREAST IMPLANTS

MENTOR® CONTOUR PROFILE™ Tissue Expanders / CPG™ Gel Breast Implants Sizing Guide – Two-Stage Breast Reconstruction

STAGE 1

Selection of the CPX™4,
and CPX™4 with Suture Tabs Expander *

CPX™4 Expander, & CPX™4 w/Suture Tabs Expander Styles 8100,9100 – Low Height

Volume	Width	Height	Proj.	Catalog #
250 cc	11,4 cm	8,1 cm	6,1 cm	354-9111
350 cc	12,7 cm	9,4 cm	6,5 cm	354-9112
450 cc	14,0 cm	10,2 cm	7,1 cm	354-9113
550 cc	15,0 cm	10,9 cm	7,4 cm	354-9114
650 cc	15,7 cm	11,2 cm	7,9 cm	354-9115
750 cc	16,5 cm	11,9 cm	8,1 cm	354-9116

CPX™4 Expander, & CPX™4 w/Suture Tabs Expander Styles 8200,9200 – Medium Height

Volume	Width	Height	Proj.	Catalog #
275 cc	10,7 cm	9,3 cm	6,2 cm	354-9211
350 cc	11,7 cm	10,0 cm	6,6 cm	354-9212
450 cc	12,7 cm	10,8 cm	7,0 cm	354-9213
550 cc	13,5 cm	11,7 cm	7,4 cm	354-9214
650 cc	14,6 cm	12,6 cm	7,6 cm	354-9215
800 cc	15,6 cm	13,3 cm	8,0 cm	354-9216

CPX™4 Expander, & CPX™4 w/Suture Tabs Expander Styles 8200,9200 – Medium Height

Volume	Width	Height	Proj.	Catalog #
275 cc	10,7 cm	9,3 cm	6,2 cm	354-9211
350 cc	11,7 cm	10,0 cm	6,6 cm	354-9212
450 cc	12,7 cm	10,8 cm	7,0 cm	354-9213
550 cc	13,5 cm	11,7 cm	7,4 cm	354-9214
650 cc	14,6 cm	12,6 cm	7,6 cm	354-9215
800 cc	15,6 cm	13,3 cm	8,0 cm	354-9216

CPX™4 Expander, & CPX™4 w/Suture Tabs Expander Styles 8300,9300 – Tall Height

Volume	Width	Height	Proj.	Catalog #
250 cc	10,1 cm	10,7 cm	5,6 cm	354-9311
350 cc	11,3 cm	11,8 cm	6,0 cm	354-9312
450 cc	12,3 cm	12,9 cm	6,5 cm	354-9313
550 cc	13,2 cm	13,8 cm	6,9 cm	354-9314
650 cc	14,0 cm	14,6 cm	7,3 cm	354-9315
750 cc	14,6 cm	15,3 cm	7,6 cm	354-9316
850 cc	15,4 cm	15,9 cm	7,9 cm	354-9317

Selection of CPG™ Gel Breast

CPG™ Implant 311

Cohesive III™, Low Height, Moderate Projection

Volume	Width	Height	Proj.	Catalog #
180 cc	11,0 cm	9,8 cm	3,7 cm	334-1101
210 cc	11,5 cm	10,3 cm	3,9 cm	334-1151
270 cc	12,5 cm	11,2 cm	4,2 cm	334-1251
300 cc	13,0 cm	11,6 cm	4,4 cm	334-1301
375 cc	14,0 cm	12,5 cm	4,7 cm	334-1401
460 cc	15,0 cm	13,4 cm	5,1 cm	334-1501
510 cc	15,5 cm	13,8 cm	5,2 cm	334-1551
560 cc	16,0 cm	14,3 cm	5,4 cm	334-1601
615 cc	16,5 cm	14,7 cm	5,6 cm	334-1651

CPG™ Implant 311

Cohesive III™, Low Height, Moderate Projection

Volume	Width	Height	Proj.	Catalog #
160 cc	10,5 cm	9,4 cm	3,6 cm	334-1051
180 cc	11,0 cm	9,8 cm	3,7 cm	334-1101
210 cc	11,5 cm	10,3 cm	3,9 cm	334-1151
235 cc	12,0 cm	10,7 cm	4,1 cm	334-1201
270 cc	12,5 cm	11,2 cm	4,2 cm	334-1251
300 cc	13,0 cm	11,6 cm	4,4 cm	334-1301
335 cc	13,5 cm	12,0 cm	4,6 cm	334-1351
415 cc	14,5 cm	12,9 cm	4,9 cm	334-1451
460 cc	15,0 cm	13,4 cm	5,1 cm	334-1501
510 cc	15,5 cm	13,8 cm	5,2 cm	334-1551
560 cc	16,0 cm	14,3 cm	5,4 cm	334-1601

CPG™ Implant 321

Cohesive III™, Medium Height, Moderate Projection

Volume	Width	Height	Proj.	Catalog #
180 cc	10,5 cm	9,9 cm	3,8 cm	354-1058
215 cc	11,0 cm	10,3 cm	3,9 cm	354-1108
245 cc	11,5 cm	10,8 cm	4,0 cm	354-1158
280 cc	12,0 cm	11,3 cm	4,2 cm	354-1208
315 cc	12,5 cm	11,8 cm	4,4 cm	354-1258
355 cc	13,0 cm	12,2 cm	4,6 cm	354-1308
395 cc	13,5 cm	12,7 cm	4,7 cm	354-1358
480 cc	14,5 cm	13,6 cm	5,0 cm	354-1458
530 cc	15,0 cm	14,1 cm	5,2 cm	354-1508
640 cc	16,0 cm	15,0 cm	5,6 cm	354-1608

CPG™ Implant 331

Cohesive III™, Tall Height, Moderate Projection

Volume	Width	Height	Proj.	Catalog #
175 cc	10,0 cm	10,2 cm	3,4 cm	334-1003
200 cc	10,5 cm	10,7 cm	3,5 cm	334-1053
230 cc	11,0 cm	11,3 cm	3,6 cm	334-1103
265 cc	11,5 cm	11,8 cm	3,7 cm	334-1153
300 cc	12,0 cm	12,3 cm	3,9 cm	334-1203
340 cc	12,5 cm	12,8 cm	4,0 cm	334-1253
380 cc	13,0 cm	13,3 cm	4,1 cm	334-1303
425 cc	13,5 cm	13,8 cm	4,3 cm	334-1353
475 cc	14,0 cm	14,3 cm	4,5 cm	334-1403
530 cc	14,5 cm	14,8 cm	4,6 cm	334-1453
585 cc	15,0 cm	15,3 cm	4,8 cm	334-1503
645 cc	15,5 cm	15,9 cm	5,0 cm	334-1553

MEMORYGEL™ BREAST IMPLANTS

*PLEASE NOTE: The CONTOUR PROFILE™ Tissue Expander Injection Dome is not MRI compatible. For detailed indications, contraindications, warning and precautions associated with the use of this device, please refer to the Product Insert Data Sheet. Individual implant dimensions may vary slightly in products of this type. Not all units conform exactly to the dimensions noted.

STAGE 2

Implant to use as a long-term implant after expansion is complete.

CPG™ Implant 312

Cohesive III™, Low Height, Moderate Plus Projection

Volume	Width	Height	Proj.	Catalog #
225 cc	11,0 cm	9,7 cm	4,7 cm	334-1107
255 cc	11,5 cm	10,2 cm	4,9 cm	334-1157
330 cc	12,5 cm	11,1 cm	5,3 cm	334-1257
370 cc	13,0 cm	11,5 cm	5,5 cm	334-1307
465 cc	14,0 cm	12,4 cm	5,9 cm	334-1407
570 cc	15,0 cm	13,3 cm	6,3 cm	334-1507
690 cc	16,0 cm	14,2 cm	6,8 cm	334-1607

CPG™ Implant 312

Cohesive III™, Low Height, Moderate Plus Projection

Volume	Width	Height	Proj.	Catalog #
195 cc	10,5 cm	9,3 cm	4,4 cm	334-1057
225 cc	11,0 cm	9,7 cm	4,7 cm	334-1107
255 cc	11,5 cm	10,2 cm	4,9 cm	334-1157
290 cc	12,0 cm	10,6 cm	5,1 cm	334-1207
330 cc	12,5 cm	11,1 cm	5,3 cm	334-1257
370 cc	13,0 cm	11,5 cm	5,5 cm	334-1307
415 cc	13,5 cm	12,0 cm	5,7 cm	334-1357
515 cc	14,5 cm	12,8 cm	6,1 cm	334-1457
570 cc	15,0 cm	13,3 cm	6,3 cm	334-1507
690 cc	16,0 cm	14,2 cm	6,8 cm	334-1607

CPG™ Implant 322

Cohesive III™, Medium Height, Moderate Plus Projection

Volume	Width	Height	Proj.	Catalog #
225 cc	10,5 cm	9,9 cm	4,4 cm	334-1055
255 cc	11,0 cm	10,3 cm	4,7 cm	334-1105
295 cc	11,5 cm	10,8 cm	4,9 cm	334-1155
330 cc	12,0 cm	11,3 cm	5,1 cm	334-1205
375 cc	12,5 cm	11,8 cm	5,3 cm	334-1255
420 cc	13,0 cm	12,2 cm	5,5 cm	334-1305
475 cc	13,5 cm	12,7 cm	5,7 cm	334-1355
585 cc	14,5 cm	13,6 cm	6,1 cm	334-1455
650 cc	15,0 cm	14,1 cm	6,3 cm	334-1505

CPG™ Implant 332

Cohesive III™, Tall Height, Moderate Plus Projection

Volume	Width	Height	Proj.	Catalog #
205 cc	10,0 cm	10,4 cm	4,2 cm	334-1009
270 cc	11,0 cm	11,5 cm	4,7 cm	334-1109
305 cc	11,5 cm	12,0 cm	4,9 cm	334-1159
350 cc	12,0 cm	12,5 cm	5,1 cm	334-1209
395 cc	12,5 cm	13,0 cm	5,3 cm	334-1259
445 cc	13,0 cm	13,5 cm	5,5 cm	334-1309
495 cc	13,5 cm	14,1 cm	5,7 cm	334-1359
555 cc	14,0 cm	14,6 cm	5,9 cm	334-1409
615 cc	14,5 cm	15,1 cm	6,1 cm	334-1459
680 cc	15,0 cm	15,6 cm	6,3 cm	334-1509

CPG™ Implant 313

Cohesive III™, Low Height, High Projection

Volume	Width	Height	Proj.	Catalog #
240 cc	11,0 cm	9,9 cm	4,9 cm	334-1106
270 cc	11,5 cm	10,3 cm	5,0 cm	334-1156
350 cc	12,5 cm	11,2 cm	5,4 cm	334-1256
395 cc	13,0 cm	11,7 cm	5,6 cm	334-1306
490 cc	14,0 cm	12,6 cm	6,1 cm	334-1406
605 cc	15,0 cm	13,5 cm	6,6 cm	334-1506

CPG™ Implant 313

Cohesive III™, Low Height, High Projection

Volume	Width	Height	Proj.	Catalog #
210 cc	10,5 cm	9,5 cm	4,8 cm	334-1056
240 cc	11,0 cm	9,9 cm	4,9 cm	334-1106
270 cc	11,5 cm	10,3 cm	5,0 cm	334-1156
310 cc	12,0 cm	10,8 cm	5,2 cm	334-1206
350 cc	12,5 cm	11,2 cm	5,4 cm	334-1256
395 cc	13,0 cm	11,7 cm	5,6 cm	334-1306
440 cc	13,5 cm	12,2 cm	5,8 cm	334-1356
545 cc	14,5 cm	13,1 cm	6,3 cm	334-1456
606 cc	15,0 cm	13,5 cm	6,6 cm	334-1506

CPG™ Implant 323

Cohesive III™, Medium Height, High Projection

Volume	Width	Height	Proj.	Catalog #
260 cc	10,5 cm	9,9 cm	5,3 cm	334-1052
300 cc	11,0 cm	10,3 cm	5,6 cm	334-1102
345 cc	11,5 cm	10,8 cm	5,8 cm	334-1152
390 cc	12,0 cm	11,3 cm	6,0 cm	334-1202
440 cc	12,5 cm	11,8 cm	6,2 cm	334-1252
495 cc	13,0 cm	12,2 cm	6,5 cm	334-1302
555 cc	13,5 cm	12,7 cm	6,7 cm	334-1352
685 cc	14,5 cm	13,6 cm	7,1 cm	334-1452

CPG™ Implant 333

Cohesive III™, Tall Height, High Projection

Volume	Width	Height	Proj.	Catalog #
250 cc	10,0 cm	10,4 cm	5,1 cm	334-1004
330 cc	11,0 cm	11,5 cm	5,6 cm	334-1104
380 cc	11,5 cm	12,0 cm	5,8 cm	334-1154
430 cc	12,0 cm	12,5 cm	6,0 cm	334-1204
485 cc	12,5 cm	13,0 cm	6,2 cm	334-1254
545 cc	13,0 cm	13,5 cm	6,5 cm	334-1304
610 cc	13,5 cm	14,1 cm	6,7 cm	334-1354
680 cc	14,0 cm	14,6 cm	6,9 cm	334-1404
755 cc	14,5 cm	15,1 cm	7,1 cm	334-1454

BECKER™ Expander/Breast Implants

SILTEX™ Round BECKER™ 25 Expander/Implants, Cohesive I™

(25% Silicone Gel, Cohesive I™, in outer lumen, 75% Saline in inner lumen)

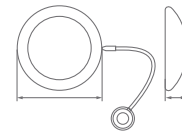

Volume	Gel Volume	TEMPORARY OVEREXPANSION VOLUMES		Total Saline	Total Gel-Saline	Diameter	Proj.	Cat.#
		Max Saline	Total Gel-Saline					
150 cc	40 cc	185 cc	225 cc	85-150 cc	125-190 cc	10,7 cm	2,4 cm	354-1500
200 cc	50 cc	250 cc	300 cc	125-200 cc	175-250 cc	11,6 cm	2,7 cm	354-2000
250 cc	60 cc	315 cc	375 cc	165-255 cc	225-315 cc	12,1 cm	3,0 cm	354-2500
300 cc	75 cc	375 cc	450 cc	200-300 cc	275-375 cc	12,9 cm	3,0 cm	354-3000
350 cc	90 cc	435 cc	525 cc	235-350 cc	325-440 cc	13,5 cm	3,0 cm	354-3500
400 cc	100 cc	500 cc	600 cc	275-400 cc	375-500 cc	13,7 cm	3,4 cm	354-4000
500 cc	125 cc	625 cc	750 cc	350-500 cc	475-625 cc	14,7 cm	3,7 cm	354-5000
600 cc	150 cc	750 cc	900 cc	425-600 cc	575-750 cc	15,6 cm	4,2 cm	354-6000
700 cc	175 cc	875 cc	1050 cc	500-700 cc	675-875 cc	16,8 cm	4,3 cm	354-7000
800 cc	200 cc	1000 cc	1200 cc	575-800 cc	775-1000 cc	17,2 cm	4,6 cm	354-8000

SILTEX™ Round BECKER™ 50 Expander/Implants, Cohesive I™

(50% Silicone Gel, Cohesive I™, in outer lumen, 50% Saline in inner lumen)

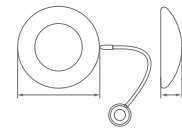

Volume	Gel Volume	Total Saline	Total Gel- Saline	Diameter	Proj.	Catalog #
300 cc	150 cc	150-200 cc	300-350 cc	12,9 cm	3,0 cm	354-1515
400 cc	200 cc	200-300 cc	400-500 cc	13,9 cm	3,4 cm	354-2020
500 cc	250 cc	250-350 cc	500-600 cc	14,7 cm	3,7 cm	354-2525
600 cc	300 cc	300-425 cc	600-725 cc	15,6 cm	4,2 cm	354-3030
700 cc	350 cc	350-500 cc	700-850 cc	16,0 cm	5,0 cm	354-3535

SILTEX™ CONTOUR PROFILE™ BECKER™ 35 Expander/Implants, Cohesive II™

(35% Silicone Gel, Cohesive II™, in outer lumen, 65% Saline in inner lumen)

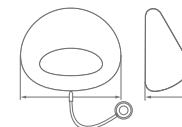

Volume	Gel Volume	TEMPORARY OVEREXPANSION VOLUMES		Total Saline	Total Gel-Saline	Width	Height	Proj.	Cat.#
		Max Saline	Total Gel-Saline						
145 cc	50 cc	120 cc	170 cc	85-95 cc	135-145 cc	9,5 cm	8,3 cm	4,2 cm	324-0955
195 cc	70 cc	155 cc	225 cc	110-125 cc	180-195 cc	10,5 cm	9,1 cm	4,6 cm	324-1055
255 cc	90 cc	205 cc	295 cc	145-165 cc	235-255 cc	11,5 cm	10,0 cm	5,1 cm	324-1155
290 cc	100 cc	235 cc	335 cc	170-190 cc	270-290 cc	12,0 cm	10,5 cm	5,3 cm	324-1205
325 cc	110 cc	270 cc	380 cc	190-215 cc	300-325 cc	12,5 cm	10,9 cm	5,5 cm	324-1255
365 cc	125 cc	300 cc	425 cc	215-240 cc	340-365 cc	13,0 cm	11,3 cm	5,7 cm	324-1305
400 cc	130 cc	335 cc	465 cc	240-270 cc	370-400 cc	13,5 cm	11,8 cm	5,9 cm	324-1355
460 cc	160 cc	375 cc	535 cc	270-300 cc	430-460 cc	14,0 cm	12,2 cm	6,2 cm	324-1405
565 cc	195 cc	460 cc	655 cc	330-370 cc	525-565 cc	15,0 cm	13,1 cm	6,6 cm	324-1505
685 cc	240 cc	555 cc	795 cc	400-445 cc	640-685 cc	16,0 cm	13,9 cm	7,0 cm	324-1605

Note: Individual implant dimensions may vary slightly in products of this type.

Not all units will conform exactly to the dimensions noted above

SPECTRA™ Adjustable Gel Breast Implants

**SILTEX™ Round SPECTRA™
Adjustable Gel Breast Implants, Cohesive I™‡**

Volume	Gel Volume	Saline Volume	NOMINAL FILL		MAXIMUM FILL		Catalog #
			Diameter	Projection	Diameter	Projection	
190 cc	180 cc	10-50cc	9,9 cm	4,1 cm	9,4 cm	5,1 cm	314-4190
215 cc	205 cc	10-50cc	10,2 cm	4,3 cm	9,8 cm	5,2 cm	314-4215
240 cc	230 cc	10-50cc	10,5 cm	4,5 cm	10,2 cm	5,3 cm	314-4240
260 cc	250 cc	10-50cc	10,9 cm	4,6 cm	10,5 cm	5,4 cm	314-4260
285 cc	275 cc	10-50cc	11,1 cm	4,7 cm	10,8 cm	5,5 cm	314-4285
310 cc	300 cc	10-50cc	11,5 cm	4,8 cm	11,1 cm	5,6 cm	314-4310
335 cc	325 cc	10-50cc	11,7 cm	4,9 cm	11,4 cm	5,7 cm	314-4335
355 cc	345 cc	10-50cc	12,0 cm	5,0 cm	11,7 cm	5,8 cm	314-4355
380 cc	370 cc	10-50cc	12,3 cm	5,1 cm	11,9 cm	5,8 cm	314-4380
405 cc	395 cc	10-50cc	12,5 cm	5,2 cm	12,2 cm	5,9 cm	314-4405
430 cc	420 cc	10-50cc	12,7 cm	5,2 cm	12,4 cm	6,0 cm	314-4430
480 cc	465 cc	15-75cc	13,2 cm	5,4 cm	12,9 cm	6,1 cm	314-4480
525 cc	510 cc	15-75cc	13,5 cm	5,6 cm	13,3 cm	6,2 cm	314-4525
575 cc	560 cc	15-75cc	14,0 cm	5,7 cm	13,8 cm	6,4 cm	314-4575
620 cc	605 cc	15-100cc	14,3 cm	5,8 cm	14,1 cm	6,5 cm	314-4620
665 cc	650 cc	15-100cc	14,7 cm	6,0 cm	14,5 cm	6,6 cm	314-4665
760 cc	745 cc	15-100cc	15,4 cm	6,3 cm	15,1 cm	6,7 cm	314-4760

**Smooth Round SPECTRA™
Adjustable Gel Breast Implants, Cohesive I™‡**

Volume	Gel Volume	Saline Volume	NOMINAL FILL		MAXIMUM FILL		Catalog #
			Diameter	Projection	Diameter	Projection	
190 cc	180 cc	10-50cc	9,7 cm	4,0 cm	9,4 cm	5,1 cm	310-4190
215 cc	205 cc	10-50cc	10,1 cm	4,2 cm	9,8 cm	5,2 cm	310-4215
240 cc	230 cc	10-50cc	10,5 cm	4,3 cm	10,2 cm	5,3 cm	310-4240
260 cc	250 cc	10-50cc	10,8 cm	4,4 cm	10,5 cm	5,4 cm	310-4260
285 cc	275 cc	10-50cc	11,1 cm	4,5 cm	10,8 cm	5,5 cm	310-4285
310 cc	300 cc	10-50cc	11,4 cm	4,6 cm	11,1 cm	5,6 cm	310-4310
335 cc	325 cc	10-50cc	11,7 cm	4,8 cm	11,4 cm	5,7 cm	310-4335
355 cc	345 cc	10-50cc	12,0 cm	4,8 cm	11,7 cm	5,8 cm	310-4355
380 cc	370 cc	10-50cc	12,2 cm	5,0 cm	11,9 cm	5,8 cm	310-4380
405 cc	395 cc	10-50cc	12,5 cm	5,0 cm	12,2 cm	5,9 cm	310-4405
430 cc	420 cc	10-50cc	12,8 cm	5,1 cm	12,4 cm	6,0 cm	310-4430
480 cc	465 cc	15-75cc	13,2 cm	5,3 cm	12,9 cm	6,1 cm	310-4480
525 cc	510 cc	15-75cc	13,6 cm	5,5 cm	13,3 cm	6,2 cm	310-4525
575 cc	560 cc	15-75cc	14,0 cm	5,6 cm	13,8 cm	6,4 cm	310-4575
620 cc	605 cc	15-100cc	14,4 cm	5,7 cm	14,1 cm	6,5 cm	310-4620
665 cc	650 cc	15-100cc	14,8 cm	5,8 cm	14,5 cm	6,6 cm	310-4665
760 cc	745 cc	15-100cc	15,5 cm	6,0 cm	15,1 cm	6,7 cm	310-4760

‡Dome Pack for postoperative adjustment can be purchased separately

Sterile Resterilizable Gel Breast Implant Sizers*

Round Gel Breast Implant Sizers, Low Profile

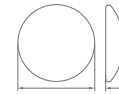

Volume	Diameter	Projection	Catalog #
100 cc	9,4 cm	1,9 cm	RSZ-1100
125 cc	10,1 cm	2,0 cm	RSZ-1125
150 cc	10,7 cm	2,2 cm	RSZ-1150
175 cc	11,3 cm	2,3 cm	RSZ-1175
200 cc	11,8 cm	2,4 cm	RSZ-1200
225 cc	12,3 cm	2,5 cm	RSZ-1225
250 cc	12,7 cm	2,6 cm	RSZ-1250
275 cc	13,1 cm	2,7 cm	RSZ-1275
300 cc	13,5 cm	2,7 cm	RSZ-1300
325 cc	13,9 cm	2,8 cm	RSZ-1325
350 cc	14,2 cm	2,9 cm	RSZ-1350
375 cc	14,5 cm	2,9 cm	RSZ-1375
400 cc	14,8 cm	3,0 cm	RSZ-1400
450 cc	15,4 cm	3,1 cm	RSZ-1450
500 cc	16,0 cm	3,3 cm	RSZ-1500
550 cc	16,5 cm	3,4 cm	RSZ-1550
600 cc	17,0 cm	3,5 cm	RSZ-1600

Round Gel Breast Implant Sizers, Moderate Profile

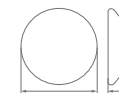

Volume	Diameter	Projection	Catalog #
100 cc	9,3 cm	2,1 cm	RSZ-7100
125 cc	10,0 cm	2,2 cm	RSZ-7125
150 cc	10,3 cm	2,3 cm	RSZ-7150
175 cc	11,2 cm	2,4 cm	RSZ-7175
200 cc	11,7 cm	2,5 cm	RSZ-7200
225 cc	12,2 cm	2,6 cm	RSZ-7225
250 cc	12,3 cm	2,8 cm	RSZ-7250
275 cc	13,2 cm	2,9 cm	RSZ-7275
300 cc	13,5 cm	3,0 cm	RSZ-7300
325 cc	13,9 cm	3,0 cm	RSZ-7325
350 cc	14,2 cm	3,1 cm	RSZ-7350
375 cc	14,4 cm	3,2 cm	RSZ-7375
400 cc	14,5 cm	3,2 cm	RSZ-7400
450 cc	14,9 cm	3,4 cm	RSZ-7450
500 cc	15,2 cm	3,6 cm	RSZ-7500
550 cc	15,9 cm	3,6 cm	RSZ-7550
600 cc	16,5 cm	3,7 cm	RSZ-7600
700 cc	17,4 cm	3,9 cm	RSZ-7700
800 cc	18,2 cm	4,1 cm	RSZ-7800

*Resterilizable up to 10 times.

Note: Individual implant dimensions may vary slightly in products of this type.

Not all units will conform exactly to the dimensions noted above

Sterile Resterilizable Gel Breast Implant Sizers* CONT'D

Round Gel Breast Implant Sizers, Moderate Plus Profile



Volume	Diameter	Projection	Catalog #
100 cc	8,2 cm	2,7 cm	RSZ-1001
125 cc	8,9 cm	2,8 cm	RSZ-1251
150 cc	9,5 cm	2,9 cm	RSZ-1501
175 cc	10,0 cm	3,1 cm	RSZ-1751
200 cc	10,5 cm	3,2 cm	RSZ-2001
225 cc	10,9 cm	3,3 cm	RSZ-2251
250 cc	11,3 cm	3,4 cm	RSZ-2501
275 cc	11,7 cm	3,5 cm	RSZ-2751
300 cc	12,0 cm	3,6 cm	RSZ-3001
325 cc	12,3 cm	3,8 cm	RSZ-3251
350 cc	12,5 cm	3,9 cm	RSZ-3501
375 cc	12,8 cm	4,0 cm	RSZ-3751
400 cc	13,1 cm	4,0 cm	RSZ-4001
450 cc	13,6 cm	4,2 cm	RSZ-4501
500 cc	14,1 cm	4,3 cm	RSZ-5001
550 cc	14,6 cm	4,5 cm	RSZ-5501
600 cc	15,0 cm	4,6 cm	RSZ-6001
700 cc	15,8 cm	4,9 cm	RSZ-7001
800 cc	16,5 cm	5,1 cm	RSZ-8001

Round Gel Breast Implant Sizers, High Profile



Volume	Diameter	Projection	Catalog #
125 cc	8,3 cm	3,5 cm	RSZ-1254
150 cc	8,8 cm	3,7 cm	RSZ-1504
175 cc	9,3 cm	3,9 cm	RSZ-1754
200 cc	9,7 cm	4,0 cm	RSZ-2004
225 cc	10,1 cm	4,2 cm	RSZ-2254
250 cc	10,5 cm	4,3 cm	RSZ-2504
275 cc	10,8 cm	4,4 cm	RSZ-2754
300 cc	11,1 cm	4,5 cm	RSZ-3004
325 cc	11,4 cm	4,6 cm	RSZ-3254
350 cc	11,7 cm	4,8 cm	RSZ-3504
375 cc	12,0 cm	4,8 cm	RSZ-3754
400 cc	12,2 cm	5,0 cm	RSZ-4004
425 cc	12,5 cm	5,0 cm	RSZ-4254
450 cc	12,8 cm	5,1 cm	RSZ-4504
500 cc	13,2 cm	5,3 cm	RSZ-5004
550 cc	13,6 cm	5,5 cm	RSZ-5504
600 cc	14,0 cm	5,6 cm	RSZ-6004
650 cc	14,4 cm	5,7 cm	RSZ-6504
700 cc	14,8 cm	5,8 cm	RSZ-7004
800 cc	15,5 cm	6,0 cm	RSZ-8004

*Resterilizable up to 10 times.

Sterile Resterilizable Gel Breast Implant Sizers* CONT'D

Round Gel Breast Implant Sizers, Ultra High Profile



Volume	Diameter	Projection	Catalog #
135 cc	7,8 cm	4,1 cm	RSZ-5135
160 cc	8,2 cm	4,3 cm	RSZ-5160
185 cc	8,4 cm	4,4 cm	RSZ-5185
215 cc	8,7 cm	4,5 cm	RSZ-5215
240 cc	9,0 cm	4,7 cm	RSZ-5240
270 cc	9,3 cm	4,8 cm	RSZ-5270
295 cc	9,7 cm	5,0 cm	RSZ-5295
320 cc	9,8 cm	5,1 cm	RSZ-5320
350 cc	10,1 cm	5,2 cm	RSZ-5350
375 cc	10,4 cm	5,3 cm	RSZ-5375
400 cc	10,6 cm	5,4 cm	RSZ-5400
430 cc	10,9 cm	5,6 cm	RSZ-5430
455 cc	11,2 cm	5,7 cm	RSZ-5455
480 cc	11,4 cm	5,8 cm	RSZ-5480
535 cc	12,0 cm	6,1 cm	RSZ-5535
590 cc	12,5 cm	6,3 cm	RSZ-5590

*Resterilizable up to 10 times.

Note: Individual implant dimensions may vary slightly in products of this type.

Not all units will conform exactly to the dimensions noted above

Sterile Resterilizable
Gel Breast Implant Sizers* CONT'D

CPG™ GEL BREAST IMPLANT SIZERS



CPG™ Implant Sizers 331
Cohesive III™, Tall Height, Moderate Projection

Volume	Width	Height	Projection	A	Arc Length	Catalog #
125 cc	9,0 cm	9,2 cm	3,2 cm	2,4 cm	3,9 cm	RSZ-0903
150 cc	9,5 cm	9,7 cm	3,3 cm	2,6 cm	4,1 cm	RSZ-0953
175 cc	10,0 cm	10,2 cm	3,4 cm	2,7 cm	4,3 cm	RSZ-1003
200 cc	10,5 cm	10,7 cm	3,5 cm	2,8 cm	4,6 cm	RSZ-1053
230 cc	11,0 cm	11,3 cm	3,6 cm	3,0 cm	4,8 cm	RSZ-1103
265 cc	11,5 cm	11,8 cm	3,7 cm	3,1 cm	5,0 cm	RSZ-1153
300 cc	12,0 cm	12,3 cm	3,9 cm	3,2 cm	5,2 cm	RSZ-1203
340 cc	12,5 cm	12,8 cm	4,0 cm	3,4 cm	5,4 cm	RSZ-1253
380 cc	13,0 cm	13,3 cm	4,1 cm	3,5 cm	5,6 cm	RSZ-1303
425 cc	13,5 cm	13,8 cm	4,3 cm	3,6 cm	5,9 cm	RSZ-1353
475 cc	14,0 cm	14,3 cm	4,5 cm	3,8 cm	6,1 cm	RSZ-1403
530 cc	14,5 cm	14,8 cm	4,6 cm	3,9 cm	6,3 cm	RSZ-1453
585 cc	15,0 cm	15,3 cm	4,8 cm	4,0 cm	6,5 cm	RSZ-1503
645 cc	15,5 cm	15,9 cm	5,0 cm	4,2 cm	6,7 cm	RSZ-1553

CPG™ Implant Sizers 321
Cohesive III™, Medium Height, Moderate Projection

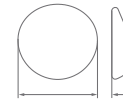

Volume	Width	Height	Projection	A	Arc Length	Catalog #
120 cc	9,0 cm	8,5 cm	3,3 cm	3,1 cm	4,3 cm	RSZ-0908
135 cc	9,5 cm	8,9 cm	3,5 cm	3,2 cm	4,5 cm	RSZ-0958
155 cc	10,0 cm	9,4 cm	3,7 cm	3,4 cm	4,7 cm	RSZ-1008
180 cc	10,5 cm	9,9 cm	3,8 cm	3,6 cm	5,0 cm	RSZ-1058
215 cc	11,0 cm	10,3 cm	3,9 cm	3,6 cm	5,1 cm	RSZ-1108
245 cc	11,5 cm	10,8 cm	4,0 cm	3,8 cm	5,3 cm	RSZ-1158
280 cc	12,0 cm	11,3 cm	4,2 cm	4,0 cm	5,6 cm	RSZ-1208
315 cc	12,5 cm	11,8 cm	4,4 cm	4,1 cm	5,8 cm	RSZ-1258
355 cc	13,0 cm	12,2 cm	4,6 cm	4,3 cm	6,0 cm	RSZ-1308
395 cc	13,5 cm	12,7 cm	4,7 cm	4,5 cm	6,3 cm	RSZ-1358
440 cc	14,0 cm	13,2 cm	4,9 cm	4,6 cm	6,5 cm	RSZ-1408
480 cc	14,5 cm	13,6 cm	5,0 cm	5,0 cm	6,9 cm	RSZ-1458
530 cc	15,0 cm	14,1 cm	5,2 cm	5,1 cm	7,2 cm	RSZ-1508
640 cc	16,0 cm	15,0 cm	5,6 cm	5,5 cm	7,6 cm	RSZ-1608
775 cc	17,0 cm	16,0 cm	5,9 cm	5,8 cm	8,1 cm	RSZ-1708

CPG™ Implant Sizers 311
Cohesive III™, Low Height, Moderate Projection

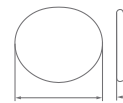

Volume	Width	Height	Projection	A	Arc Length	Catalog #
100 cc	9,0 cm	8,0 cm	3,0 cm	2,5 cm	4,1 cm	RSZ-0090
120 cc	9,5 cm	8,5 cm	3,2 cm	2,6 cm	4,3 cm	RSZ-0095
140 cc	10,0 cm	8,9 cm	3,4 cm	2,8 cm	4,5 cm	RSZ-0100
160 cc	10,5 cm	9,4 cm	3,6 cm	2,9 cm	4,7 cm	RSZ-0105
180 cc	11,0 cm	9,8 cm	3,7 cm	3,0 cm	5,0 cm	RSZ-0110
210 cc	11,5 cm	10,3 cm	3,9 cm	3,2 cm	5,2 cm	RSZ-0115
235 cc	12,0 cm	10,7 cm	4,1 cm	3,3 cm	5,4 cm	RSZ-0120
270 cc	12,5 cm	11,2 cm	4,2 cm	3,5 cm	5,6 cm	RSZ-0125
300 cc	13,0 cm	11,6 cm	4,4 cm	3,6 cm	5,9 cm	RSZ-0130
335 cc	13,5 cm	12,0 cm	4,6 cm	3,7 cm	6,1 cm	RSZ-0135
375 cc	14,0 cm	12,5 cm	4,7 cm	3,9 cm	6,3 cm	RSZ-0140
415 cc	14,5 cm	12,9 cm	4,9 cm	4,0 cm	6,5 cm	RSZ-0145
460 cc	15,0 cm	13,4 cm	5,1 cm	4,1 cm	6,8 cm	RSZ-0150
510 cc	15,5 cm	13,8 cm	5,2 cm	4,3 cm	7,0 cm	RSZ-0155
560 cc	16,0 cm	14,3 cm	5,4 cm	4,4 cm	7,2 cm	RSZ-0160
615 cc	16,5 cm	14,7 cm	5,6 cm	4,6 cm	7,4 cm	RSZ-0165

*Resterilizable up to 10 times.

Sterile Resterilizable Gel Breast Implant Sizers* CONT'D

CPG™ GEL BREAST IMPLANT SIZERS

CPG™ Implant Sizers 332 Cohesive III™, Tall Height, Moderate Plus Projection



Volume	Width	Height	Projection	A	Arc Length	Catalog #
145 cc	9,0 cm	9,4 cm	3,8 cm	2,8 cm	4,6 cm	RSZ-0909
175 cc	9,5 cm	9,9 cm	4,0 cm	3,0 cm	4,9 cm	RSZ-0959
205 cc	10,0 cm	10,4 cm	4,2 cm	3,1 cm	5,1 cm	RSZ-1009
235 cc	10,5 cm	10,9 cm	4,4 cm	3,3 cm	5,4 cm	RSZ-1059
270 cc	11,0 cm	11,5 cm	4,7 cm	3,5 cm	5,7 cm	RSZ-1109
305 cc	11,5 cm	12,0 cm	4,9 cm	3,6 cm	5,9 cm	RSZ-1159
350 cc	12,0 cm	12,5 cm	5,1 cm	3,8 cm	6,2 cm	RSZ-1209
395 cc	12,5 cm	13,0 cm	5,3 cm	3,9 cm	6,4 cm	RSZ-1259
445 cc	13,0 cm	13,5 cm	5,5 cm	4,1 cm	6,7 cm	RSZ-1309
495 cc	13,5 cm	14,1 cm	5,7 cm	4,2 cm	7,0 cm	RSZ-1359
555 cc	14,0 cm	14,6 cm	5,9 cm	4,4 cm	7,2 cm	RSZ-1409
615 cc	14,5 cm	15,1 cm	6,1 cm	4,6 cm	7,5 cm	RSZ-1459
680 cc	15,0 cm	15,6 cm	6,3 cm	4,7 cm	7,7 cm	RSZ-1509

CPG™ Implant Sizers 322 Cohesive III™, Medium Height, Moderate Plus Projection

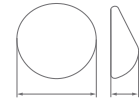

Volume	Width	Height	Projection	A	Arc Length	Catalog #
140 cc	9,0 cm	8,5 cm	3,8 cm	2,9 cm	4,7 cm	RSZ-0905
165 cc	9,5 cm	8,9 cm	4,0 cm	3,0 cm	4,9 cm	RSZ-0955
195 cc	10,0 cm	9,4 cm	4,2 cm	3,2 cm	5,2 cm	RSZ-1005
225 cc	10,5 cm	9,9 cm	4,4 cm	3,3 cm	5,5 cm	RSZ-1055
255 cc	11,0 cm	10,3 cm	4,7 cm	3,5 cm	5,7 cm	RSZ-1105
295 cc	11,5 cm	10,8 cm	4,9 cm	3,7 cm	6,0 cm	RSZ-1155
330 cc	12,0 cm	11,3 cm	5,1 cm	3,8 cm	6,3 cm	RSZ-1205
375 cc	12,5 cm	11,8 cm	5,3 cm	4,0 cm	6,5 cm	RSZ-1255
420 cc	13,0 cm	12,2 cm	5,5 cm	4,1 cm	6,8 cm	RSZ-1305
475 cc	13,5 cm	12,7 cm	5,7 cm	4,3 cm	7,0 cm	RSZ-1355
525 cc	14,0 cm	13,2 cm	5,9 cm	4,5 cm	7,3 cm	RSZ-1405
585 cc	14,5 cm	13,6 cm	6,1 cm	4,6 cm	7,6 cm	RSZ-1455
650 cc	15,0 cm	14,1 cm	6,3 cm	4,8 cm	7,8 cm	RSZ-1505

CPG™ Implant Sizers 312 Cohesive III™, Low Height, Moderate Plus Projection



Volume	Width	Height	Projection.	A	Arc Length	Catalog #
125 cc	9,0 cm	8,0 cm	3,8 cm	2,5 cm	4,6 cm	RSZ-0907
145 cc	9,5 cm	8,4 cm	4,0 cm	2,6 cm	4,8 cm	RSZ-0957
170 cc	10,0 cm	8,8 cm	4,2 cm	2,7 cm	5,1 cm	RSZ-1007
195 cc	10,5 cm	9,3 cm	4,4 cm	2,9 cm	5,4 cm	RSZ-1057
225 cc	11,0 cm	9,7 cm	4,7 cm	3,0 cm	5,6 cm	RSZ-1107
255 cc	11,5 cm	10,2 cm	4,9 cm	3,1 cm	5,9 cm	RSZ-1157
290 cc	12,0 cm	10,6 cm	5,1 cm	3,3 cm	6,1 cm	RSZ-1207
330 cc	12,5 cm	11,1 cm	5,3 cm	3,4 cm	6,4 cm	RSZ-1257
370 cc	13,0 cm	11,5 cm	5,5 cm	3,6 cm	6,6 cm	RSZ-1307
415 cc	13,5 cm	12,0 cm	5,7 cm	3,7 cm	6,9 cm	RSZ-1357
465 cc	14,0 cm	12,4 cm	5,9 cm	3,8 cm	7,1 cm	RSZ-1407
515 cc	14,5 cm	12,8 cm	6,1 cm	4,0 cm	7,4 cm	RSZ-1457
570 cc	15,0 cm	13,3 cm	6,3 cm	4,1 cm	7,7 cm	RSZ-1507
690 cc	16,0 cm	14,2 cm	6,8 cm	4,4 cm	8,2 cm	RSZ-1607

*Resterilizable up to 10 times.

Note: Individual implant dimensions may vary slightly in products of this type.

Not all units will conform exactly to the dimensions noted above

Sterile Resterilizable Gel Breast Implant Sizers* CONT'D

CPG™ GEL BREAST IMPLANT SIZERS

CPG™ Implant Sizers 333 Cohesive III™, Tall Height, High Projection



Volume	Width	Height	Projection	A	Arc Length	Catalog #
180 cc	9,0 cm	9,4 cm	4,6 cm	3,1 cm	5,5 cm	RSZ-4090
215 cc	9,5 cm	9,9 cm	4,8 cm	3,3 cm	5,8 cm	RSZ-4095
250 cc	10,0 cm	10,4 cm	5,1 cm	3,4 cm	6,1 cm	RSZ-4100
290 cc	10,5 cm	10,9 cm	5,3 cm	3,6 cm	6,4 cm	RSZ-4105
330 cc	11,0 cm	11,5 cm	5,6 cm	3,8 cm	6,8 cm	RSZ-4110
380 cc	11,5 cm	12,0 cm	5,8 cm	3,9 cm	7,1 cm	RSZ-4115
430 cc	12,0 cm	12,5 cm	6,0 cm	4,1 cm	7,4 cm	RSZ-4120
485 cc	12,5 cm	13,0 cm	6,2 cm	4,3 cm	7,7 cm	RSZ-4125
545 cc	13,0 cm	13,5 cm	6,5 cm	4,5 cm	8,0 cm	RSZ-4130
610 cc	13,5 cm	14,1 cm	6,7 cm	4,6 cm	8,3 cm	RSZ-4135
680 cc	14,0 cm	14,6 cm	6,9 cm	4,8 cm	8,6 cm	RSZ-4140
755 cc	14,5 cm	15,1 cm	7,1 cm	5,0 cm	8,9 cm	RSZ-4145

CPG™ Implant Sizers 323 Cohesive III™, Medium Height, High Projection



Volume	Width	Height	Projection	A	Arc Length	Catalog #
165 cc	9,0 cm	8,5 cm	4,6 cm	3,0 cm	5,3 cm	RSZ-0902
195 cc	9,5 cm	8,9 cm	4,8 cm	3,2 cm	5,6 cm	RSZ-0952
225 cc	10,0 cm	9,4 cm	5,1 cm	3,4 cm	5,9 cm	RSZ-1002
260 cc	10,5 cm	9,9 cm	5,3 cm	3,5 cm	6,2 cm	RSZ-1052
300 cc	11,0 cm	10,3 cm	5,6 cm	3,7 cm	6,5 cm	RSZ-1102
345 cc	11,5 cm	10,8 cm	5,8 cm	3,9 cm	6,8 cm	RSZ-1152
390 cc	12,0 cm	11,3 cm	6,0 cm	4,0 cm	7,1 cm	RSZ-1202
440 cc	12,5 cm	11,8 cm	6,2 cm	4,2 cm	7,4 cm	RSZ-1252
495 cc	13,0 cm	12,2 cm	6,5 cm	4,4 cm	7,7 cm	RSZ-1302
555 cc	13,5 cm	12,7 cm	6,7 cm	4,5 cm	8,0 cm	RSZ-1352
620 cc	14,0 cm	13,2 cm	6,9 cm	4,7 cm	8,3 cm	RSZ-1402
685 cc	14,5 cm	13,6 cm	7,1 cm	4,9 cm	8,6 cm	RSZ-1452

CPG™ Implant Sizers 313 Cohesive III™, Low Height, High Projection



Volume	Width	Height	Projection	A	Arc Length	Catalog #
130 cc	9,0 cm	8,1 cm	4,4 cm	2,6 cm	5,2 cm	RSZ-0906
155 cc	9,5 cm	8,6 cm	4,5 cm	2,7 cm	5,4 cm	RSZ-0956
180 cc	10,0 cm	9,0 cm	4,6 cm	2,9 cm	5,7 cm	RSZ-1006
210 cc	10,5 cm	9,5 cm	4,8 cm	3,0 cm	6,0 cm	RSZ-1056
240 cc	11,0 cm	9,9 cm	4,9 cm	3,2 cm	6,3 cm	RSZ-1106
270 cc	11,5 cm	10,3 cm	5,0 cm	3,3 cm	6,6 cm	RSZ-1156
310 cc	12,0 cm	10,8 cm	5,2 cm	3,5 cm	6,9 cm	RSZ-1206
350 cc	12,5 cm	11,2 cm	5,4 cm	3,6 cm	7,2 cm	RSZ-1256
395 cc	13,0 cm	11,7 cm	5,6 cm	3,8 cm	7,4 cm	RSZ-1306
440 cc	13,5 cm	12,2 cm	5,8 cm	3,9 cm	7,7 cm	RSZ-1356
490 cc	14,0 cm	12,6 cm	6,1 cm	4,0 cm	8,0 cm	RSZ-1406
545 cc	14,5 cm	13,1 cm	6,3 cm	4,2 cm	8,3 cm	RSZ-1456
605 cc	15,0 cm	13,5 cm	6,6 cm	4,3 cm	8,6 cm	RSZ-1506

*Resterilizable up to 10 times.

CONTOUR PROFILE™ Tissue Expanders

CPX2™ Tissue Expander, Low Height, Style 6100*

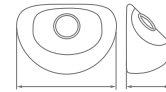

Volume	Width	Height	Projection	Catalog #
250 cc	11,4 cm	8,1 cm	6,1 cm	354-6111
350 cc	12,7 cm	9,4 cm	6,5 cm	354-6112
450 cc	14,0 cm	10,2 cm	7,1 cm	354-6113
550 cc	15,0 cm	10,9 cm	7,4 cm	354-6114
650 cc	15,7 cm	11,2 cm	7,9 cm	354-6115
750 cc	16,5 cm	11,9 cm	8,1 cm	354-6116

CPX2™ Tissue Expander, Medium Height, Style 6200*

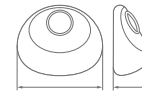

Volume	Width	Height	Projection	Catalog #
275 cc	10,7 cm	9,3 cm	6,2 cm	354-6211
350 cc	11,7 cm	10,0 cm	6,6 cm	354-6212
450 cc	12,7 cm	10,8 cm	7,0 cm	354-6213
550 cc	13,5 cm	11,7 cm	7,4 cm	354-6214
650 cc	14,6 cm	12,6 cm	7,6 cm	354-6215
800 cc	15,6 cm	13,3 cm	8,0 cm	354-6216

CPX2™ Tissue Expander, Tall Height, Style 6300*



Volume	Width	Height	Projection	Catalog #
250 cc	10,1 cm	10,7 cm	5,6 cm	354-6311
350 cc	11,3 cm	11,8 cm	6,0 cm	354-6312
450 cc	12,3 cm	12,9 cm	6,5 cm	354-6313
550 cc	13,2 cm	13,8 cm	6,9 cm	354-6314
650 cc	14,0 cm	14,6 cm	7,3 cm	354-6315
750 cc	14,6 cm	15,3 cm	7,6 cm	354-6316
850 cc	15,4 cm	15,9 cm	7,9 cm	354-6317

*Includes CENTERSCOPE™ Magnetic Detection Device

PLEASE NOTE: CONTOUR PROFILE™ Tissue Expanders are not MRI compatible

Note: Individual implant dimensions may vary slightly in products of this type.

Not all units will conform exactly to the dimensions noted above

MENTOR® CPX™4 BREAST TISSUE EXPANDER

THREE CONTOURED SHAPES ACCOMMODATE ALL YOUR NEEDS.

For more information or to order please contact Mentor® customer service at 08000 327 326 or visit www.mentormedical.co.uk

BufferZone™ Self-Sealing Patch & posterior Dacron® Patch

- Protecting the chest wall whilst driving lower pole expansion to mimic the shape of the natural breast

Improved Stronger Magnet*

- Easier to locate injection dome for larger patients

Enhanced smooth, flat injection dome and shell pliability*

- Helps ease insertion and removal through incision

Better more pliant proprietary BufferZone™ Patch*

- Enhanced patient comfort

Patented SILTEX® Texture

- Prevents the pooling or sequestration of body fluids

Implant Matching

- Matching range of definitive implants to be used after tissue expansion



* Compared with the MENTOR® CPX2™ and CPX3™ Breast Tissue Expanders.

CONTOUR PROFILE™ Tissue Expanders

CPX™4 Tissue Expander, Low Height, Style 8100*



Volume	Width	Height	Projection	Catalog #
250 cc	11,4 cm	8,1 cm	6,1 cm	354-8111
350 cc	12,7 cm	9,4 cm	6,5 cm	354-8112
450 cc	14,0 cm	10,2 cm	7,1 cm	354-8113
550 cc	15,0 cm	10,9 cm	7,4 cm	354-8114
650 cc	15,7 cm	11,2 cm	7,9 cm	354-8115
750 cc	16,5 cm	11,9 cm	8,1 cm	354-8116

CPX™4 Tissue Expander, Medium Height, Style 8200*



Volume	Width	Height	Projection	Catalog #
275 cc	10,7 cm	9,3 cm	6,2 cm	354-8211
350 cc	11,7 cm	10,0 cm	6,6 cm	354-8212
450 cc	12,7 cm	10,8 cm	7,0 cm	354-8213
550 cc	13,5 cm	11,7 cm	7,4 cm	354-8214
650 cc	14,6 cm	12,6 cm	7,6 cm	354-8215
800 cc	15,6 cm	13,3 cm	8,0 cm	354-8216

CPX™4 Tissue Expander, Tall Height, Style 8300*



Volume	Width	Height	Projection	Catalog #
250 cc	10,1 cm	10,7 cm	5,6 cm	354-8311
350 cc	11,3 cm	11,8 cm	6,0 cm	354-8312
450 cc	12,3 cm	12,9 cm	6,5 cm	354-8313
550 cc	13,2 cm	13,8 cm	6,9 cm	354-8314
650 cc	14,0 cm	14,6 cm	7,3 cm	354-8315
750 cc	14,6 cm	15,3 cm	7,6 cm	354-8316
850 cc	15,4 cm	15,9 cm	7,9 cm	354-8317

*Includes CENTERSCOPE™ Magnetic Detection Device

PLEASE NOTE: CONTOUR PROFILE™ Tissue Expanders are not MRI compatible

Note: Individual implant dimensions may vary slightly in products of this type.

Not all units will conform exactly to the dimensions noted above

CONTOUR PROFILE™ Tissue Expanders

CPX™4 with Suture Tabs Tissue Expander, Low Height, Style 9100*



Volume	Width	Height	Projection	Catalog #
250 cc	11,4 cm	8,1 cm	6,1 cm	354-9111
350 cc	12,7 cm	9,4 cm	6,5 cm	354-9112
450 cc	14,0 cm	10,2 cm	7,1 cm	354-9113
550 cc	15,0 cm	10,9 cm	7,4 cm	354-9114
650 cc	15,7 cm	11,2 cm	7,9 cm	354-9115
750 cc	16,5 cm	11,9 cm	8,1 cm	354-9116

CPX™4 with Suture Tabs Tissue Expander, Medium Height, Style 9200*

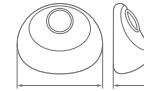

Volume	Width	Height	Projection	Catalog #
275 cc	10,7 cm	9,3 cm	6,2 cm	354-9211
350 cc	11,7 cm	10,0 cm	6,6 cm	354-9212
450 cc	12,7 cm	10,8 cm	7,0 cm	354-9213
550 cc	13,5 cm	11,7 cm	7,4 cm	354-9214
650 cc	14,6 cm	12,6 cm	7,6 cm	354-9215
800 cc	15,6 cm	13,3 cm	8,0 cm	354-9216

CPX™4 with Suture Tabs Tissue Expander, Tall Height, Style 9300*

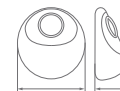

Volume	Width	Height	Projection	Catalog #
250 cc	10,1 cm	10,7 cm	5,6 cm	354-9311
350 cc	11,3 cm	11,8 cm	6,0 cm	354-9312
450 cc	12,3 cm	12,9 cm	6,5 cm	354-9313
550 cc	13,2 cm	13,8 cm	6,9 cm	354-9314
650 cc	14,0 cm	14,6 cm	7,3 cm	354-9315
750 cc	14,6 cm	15,3 cm	7,6 cm	354-9316
850 cc	15,4 cm	15,9 cm	7,9 cm	354-9317

*Includes CENTERSCOPE™ Magnetic Detection Device

PLEASE NOTE: CONTOUR PROFILE™ Tissue Expanders are not MRI compatible

Note: Individual implant dimensions may vary slightly in products of this type.

Not all units will conform exactly to the dimensions noted above

Other Tissue Expanders

Smooth Round Tissue Expanders

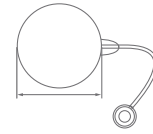

Device Volume	Diameter	Projection	Catalog #
400 cc	11,3 cm	5,9 cm	350-4305M
550 cc	13,4 cm	5,8 cm	350-4307M
700 cc	14,6 cm	6,7 cm	350-4304M
850 cc	15,0 cm	7,2 cm	350-4308M
1000 cc	15,5 cm	7,8 cm	350-4306M

Smooth Elliptical Tissue Expanders



Device Volume	Length	Width	Nominal Projection	TEMPORARY OVEREXPANSION		Catalog #
				Projection	Max. Volume	
25 cc	6,0 cm	4,0 cm	2,3 cm	4,5 cm	75 cc	350-5301M
50 cc	8,0 cm	5,0 cm	2,5 cm	5,3 cm	150 cc	350-5302M
75 cc	10,0 cm	6,0 cm	2,1 cm	6,0 cm	225 cc	350-5303M
150 cc	12,0 cm	7,0 cm	3,2 cm	7,2 cm	450 cc	350-5304M
250 cc	14,0 cm	8,0 cm	4,5 cm	9,0 cm	750 cc	350-5305M
125 cc	15,0 cm	5,0 cm	3,3 cm	6,5 cm	375 cc	350-5306M

Smooth Crescent Tissue Expanders

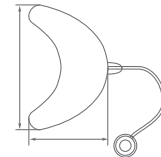

Device Volume	Length	Width	Projection	Catalog #
50 cc	9,0 cm	5,7 cm	2,7 cm	350-4312M
100 cc	11,0 cm	6,9 cm	3,7 cm	350-4313M
200 cc	14,6 cm	7,5 cm	4,3 cm	350-4314M
300 cc	16,5 cm	10,3 cm	4,7 cm	350-4315M
400 cc	18,2 cm	11,4 cm	5,2 cm	350-4316M
500 cc	19,6 cm	12,4 cm	5,5 cm	350-4317M

Smooth Rectangle Tissue Expanders

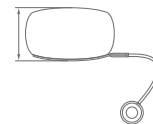

Device Volume	Length	Width	Projection	Catalog #
50 cc	6,9 cm	3,2 cm	3,2 cm	350-4309M
100 cc	6,6 cm	5,1 cm	5,6 cm	350-4301M
250 cc	10,4 cm	7,3 cm	5,6 cm	350-4302M
400 cc	10,6 cm	9,3 cm	6,6 cm	350-4303M
550 cc	13,7 cm	7,1 cm	7,7 cm	350-4310M
700 cc	15,0 cm	8,0 cm	7,9 cm	350-4311M

Round Saline Breast Implants

Smooth Round Breast Implants, Moderate Plus Profile

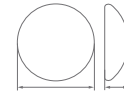

NOMINAL FILL			MAXIMUM FILL			Catalog #	Sterile Saline Sizer [†]
Volume	Diameter	Projection	Volume	Diameter	Projection		
175 cc	9,5 cm	3,5 cm	210 cc	9,3 cm	4,2 cm	350-2175	351-2175SZ
200 cc	10,0 cm	3,7 cm	240 cc	9,7 cm	4,4 cm	350-2200	351-2200SZ
225 cc	10,4 cm	3,8 cm	270 cc	10,1 cm	4,6 cm	350-2225	351-2225SZ
250 cc	10,8 cm	4,0 cm	300 cc	10,5 cm	4,7 cm	350-2250	351-2250SZ
275 cc	11,0 cm	4,1 cm	330 cc	10,8 cm	4,9 cm	350-2275	351-2275SZ
300 cc	11,5 cm	4,3 cm	360 cc	11,2 cm	5,0 cm	350-2300	351-2300SZ
325 cc	11,9 cm	4,4 cm	390 cc	11,5 cm	5,2 cm	350-2325	351-2325SZ
350 cc	12,1 cm	4,5 cm	420 cc	11,7 cm	5,3 cm	350-2350	351-2350SZ
375 cc	12,3 cm	4,6 cm	450 cc	12,0 cm	5,4 cm	350-2375	351-2375SZ
400 cc	12,6 cm	4,7 cm	480 cc	12,3 cm	5,5 cm	350-2400	351-2400SZ
425 cc	12,9 cm	4,8 cm	510 cc	12,5 cm	5,6 cm	350-2425	351-2425SZ
450 cc	13,0 cm	4,9 cm	540 cc	12,8 cm	5,7 cm	350-2450	351-2450SZ
475 cc	13,3 cm	5,0 cm	570 cc	13,0 cm	5,8 cm	350-2475	351-2475SZ
500 cc	13,6 cm	5,1 cm	600 cc	13,2 cm	5,9 cm	350-2500	351-2500SZ
550 cc	14,0 cm	5,3 cm	660 cc	13,7 cm	6,1 cm	350-2550	351-2550SZ
600 cc	14,5 cm	5,5 cm	720 cc	14,1 cm	6,3 cm	350-2600	351-2600SZ
650 cc	14,8 cm	5,6 cm	780 cc	14,4 cm	6,5 cm	350-2650	351-2650SZ
700 cc	15,2 cm	5,8 cm	840 cc	14,8 cm	6,6 cm	350-2700	351-2700SZ
750 cc	15,6 cm	5,9 cm	900 cc	15,1 cm	6,8 cm	350-2750	351-2750SZ
800 cc	16,1 cm	6,0 cm	960 cc	15,5 cm	7,0 cm	350-2800	351-2800SZ
850 cc	16,4 cm	6,3 cm	1020 cc	cm	cm	350-2850	351-2850SZ
900 cc	16,6 cm	6,5 cm	1080 cc	cm	cm	350-2900	351-2900SZ

Smooth Round Breast Implants, High Profile

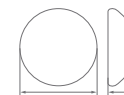

NOMINAL FILL			MAXIMUM FILL			Catalog #	Sterile Saline Sizer [†]
Volume	Diameter	Projection	Volume	Diameter	Projection		
170 cc	9,0 cm	4,0 cm	200 cc	8,8 cm	4,9 cm	350-3170	
190 cc	9,3 cm	4,1 cm	225 cc	9,1 cm	5,1 cm	350-3190	351-3190SZ
210 cc	9,6 cm	4,2 cm	250 cc	9,5 cm	5,3 cm	350-3210	
230 cc	10,0 cm	4,3 cm	275 cc	9,8 cm	5,5 cm	350-3230	351-3230SZ
250 cc	10,2 cm	4,5 cm	300 cc	10,0 cm	5,6 cm	350-3250	
270 cc	10,4 cm	4,6 cm	325 cc	10,2 cm	5,8 cm	350-3270	351-3270SZ
290 cc	10,8 cm	4,7 cm	350 cc	10,5 cm	5,9 cm	350-3290	351-3290SZ
310 cc	11,0 cm	4,8 cm	375 cc	10,7 cm	6,0 cm	350-3310	351-3310SZ
330 cc	11,3 cm	4,8 cm	400 cc	11,0 cm	6,2 cm	350-3330	351-3330SZ
380 cc	11,7 cm	5,2 cm	450 cc	11,4 cm	6,4 cm	350-3380	351-3380SZ
420 cc	12,0 cm	5,4 cm	500 cc	11,7 cm	6,7 cm	350-3420	351-3420SZ
460 cc	12,4 cm	5,5 cm	550 cc	12,1 cm	6,9 cm	350-3460	
500 cc	12,8 cm	5,6 cm	600 cc	12,4 cm	7,1 cm	350-3500	351-3500SZ
560 cc	13,4 cm	5,7 cm	675 cc	13,1 cm	7,3 cm	350-3560	
630 cc	13,8 cm	5,9 cm	750 cc	13,4 cm	7,4 cm	350-3630	351-3630SZ

[†]Single Use Only

Round Saline Breast Implants

SILTEX™ Round Breast Implants, Moderate Profile

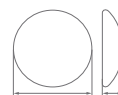

NOMINAL FILL			MAXIMUM FILL		Catalog #	Sterile Saline Sizer ¹
Volume	Diameter	Projection	Volume			
125 cc	9,5 cm	3,0 cm	150 cc		354-2610	351-125SZ
150 cc	10,0 cm	3,1 cm	175 cc		354-2615	
175 cc	10,6 cm	3,3 cm	200 cc		354-2620	351-175SZ
200 cc	11,0 cm	3,4 cm	225 cc		354-2625	
225 cc	11,5 cm	3,5 cm	250 cc		354-2630	351-225SZ
250 cc	11,9 cm	3,6 cm	275 cc		354-2635	
275 cc	12,3 cm	3,7 cm	300 cc		354-2640	351-275SZ
300 cc	12,6 cm	3,7 cm	325 cc		354-2645	
325 cc	13,0 cm	3,8 cm	375 cc		354-2650	351-325SZ
350 cc	13,3 cm	3,9 cm	400 cc		354-2655	
375 cc	13,6 cm	4,0 cm	425 cc		354-2660	351-375SZ
425 cc	14,2 cm	4,1 cm	475 cc		354-2670	351-425SZ
475 cc	14,8 cm	4,2 cm	525 cc		354-2680	351-475SZ

Smooth Round Breast Implants, Moderate Profile



NOMINAL FILL			MAXIMUM FILL			Catalog #	Sterile Saline Sizer ¹
Volume	Diameter	Projection	Volume	Diameter	Projection		
125 cc	9,5 cm	3,0 cm	150 cc	9,1 cm	3,4 cm	350-1610	351-125SZ
150 cc	10,0 cm	3,1 cm	175 cc	9,6 cm	3,7 cm	350-1615	
175 cc	10,6 cm	3,3 cm	200 cc	10,0 cm	3,9 cm	350-1620	351-175SZ
200 cc	11,0 cm	3,4 cm	225 cc	10,4 cm	3,9 cm	350-1625	
225 cc	11,5 cm	3,5 cm	250 cc	10,9 cm	4,0 cm	350-1630	351-225SZ
250 cc	11,9 cm	3,6 cm	275 cc	11,2 cm	4,1 cm	350-1635	
275 cc	12,3 cm	3,7 cm	300 cc	11,7 cm	4,2 cm	350-1640	351-275SZ
300 cc	12,6 cm	3,7 cm	325 cc	12,1 cm	4,3 cm	350-1645	
325 cc	13,0 cm	3,8 cm	375 cc	12,3 cm	4,5 cm	350-1650	351-325SZ
350 cc	13,3 cm	3,9 cm	400 cc	12,6 cm	4,7 cm	350-1655	
375 cc	13,6 cm	4,0 cm	425 cc	12,8 cm	4,8 cm	350-1660	351-375SZ
425 cc	14,2 cm	4,1 cm	475 cc	13,5 cm	4,9 cm	350-1670	351-425SZ
475 cc	14,8 cm	4,2 cm	525 cc	14,2 cm	4,9 cm	350-1680	351-475SZ
525 cc	15,0 cm	4,2 cm	575 cc	14,5 cm	5,1 cm	350-1685	
575 cc	15,0 cm	4,5 cm	625 cc	14,8 cm	5,1 cm	350-1690	
625 cc	15,2 cm	4,6 cm	700 cc	14,9 cm	5,6 cm	350-1695	
700 cc	15,6 cm	4,9 cm	775 cc	14,9 cm	5,8 cm	350-1697	

¹Single Use Only

Note: Individual implant dimensions may vary slightly in products of this type.

Not all units will conform exactly to the dimensions noted above

CONTOUR PROFILE™ Saline Breast Implants

SILTEX™ CONTOUR PROFILE™ Breast Implants, Moderate Profile

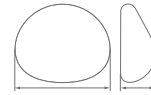

Volume	NOMINAL FILL			MAXIMUM FILL		Catalog #
	Width	Height	Projection	Volume		
175 cc	10,2 cm	8,5 cm	4,3 cm	200 cc		354-2910
225 cc	11,2 cm	9,4 cm	4,5 cm	250 cc		354-2911
275 cc	12,2 cm	10,3 cm	4,5 cm	300 cc		354-2912
350 cc	13,1 cm	11,0 cm	4,7 cm	400 cc		354-2913
425 cc	13,8 cm	11,6 cm	5,2 cm	475 cc		354-2914
525 cc	14,9 cm	12,5 cm	5,6 cm	575 cc		354-2915

SILTEX™ CONTOUR PROFILE™ Breast Implants, High Profile

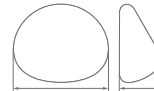

Volume	NOMINAL FILL			MAXIMUM FILL		Sterile Saline Sizer†
	Width	Height	Projection	Volume	Catalog #	
275 cc	11,5 cm	9,5 cm	5,1 cm	300 cc	354-2711	351-0711SZ
350 cc	12,3 cm	10,5 cm	5,3 cm	400 cc	354-2712	351-0712SZ
450 cc	13,2 cm	11,0 cm	6,1 cm	500 cc	354-2713	351-0713SZ
550 cc	14,0 cm	11,9 cm	6,4 cm	600 cc	354-2714	351-0714SZ
650 cc	15,0 cm	12,7 cm	6,6 cm	725 cc	354-2715	351-0715SZ

Note: Individual implant dimensions may vary slightly in products of this type.
Not all units will conform exactly to the dimensions noted above

SPECTRUM™ Post-Operatively Adjustable Saline Breast Implants

Smooth Round SPECTRUM™ Implants

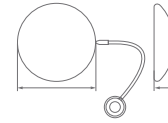

Temp. Volume	Min. Volume	NOMINAL FILL			MAXIMUM FILL			Catalog #
		Final Volume	Diameter	Projection	Final Volume	Diameter	Projection	
125 cc	105 cc	125 cc	9,4 cm	2,7 cm	150 cc	9,3 cm	3,2 cm	350-1410
175 cc	150 cc	175 cc	10,3 cm	3,1 cm	210 cc	10,2 cm	3,8 cm	350-1420
225 cc	190 cc	225 cc	10,8 cm	3,5 cm	270 cc	10,9 cm	4,3 cm	350-1430
275 cc	230 cc	275 cc	11,6 cm	3,8 cm	330 cc	11,5 cm	4,6 cm	350-1440
325 cc	275 cc	325 cc	12,4 cm	4,0 cm	390 cc	12,1 cm	4,9 cm	350-1450
375 cc	320 cc	375 cc	13,5 cm	4,1 cm	450 cc	13,0 cm	4,9 cm	350-1460
425 cc	360 cc	425 cc	14,0 cm	4,2 cm	510 cc	13,7 cm	4,8 cm	350-1470
475 cc	405 cc	475 cc	14,3 cm	4,4 cm	570 cc	13,8 cm	5,4 cm	350-1480
525 cc	450 cc	525 cc	15,0 cm	4,4 cm	630 cc	14,4 cm	5,6 cm	350-1485
575 cc	490 cc	575 cc	14,7 cm	4,8 cm	690 cc	14,2 cm	6,0 cm	350-1490

SILTEX™ Round SPECTRUM™ Implants

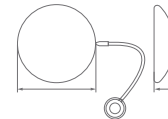

Temp. Volume	Min. Volume	NOMINAL FILL			MAXIMUM FILL			Catalog #
		Final Volume	Diameter	Projection	Final Volume	Diameter	Projection	
125 cc	105 cc	125 cc	9,4 cm	3,0 cm	150 cc	9,2 cm	3,5 cm	354-2410M
175 cc	150 cc	175 cc	10,5 cm	3,1 cm	210 cc	10,4 cm	3,9 cm	354-2420M
225 cc	190 cc	225 cc	11,3 cm	3,3 cm	270 cc	11,1 cm	4,2 cm	354-2430M
275 cc	235 cc	275 cc	12,0 cm	3,6 cm	330 cc	11,4 cm	4,4 cm	354-2440M
325 cc	275 cc	325 cc	12,9 cm	3,7 cm	390 cc	12,6 cm	4,5 cm	354-2450M
375 cc	320 cc	375 cc	13,4 cm	3,9 cm	450 cc	13,1 cm	4,8 cm	354-2460M
425 cc	360 cc	425 cc	14,0 cm	4,2 cm	510 cc	13,6 cm	5,0 cm	354-2470M
475 cc	400 cc	475 cc	14,5 cm	4,5 cm	570 cc	14,2 cm	5,7 cm	354-2480M

SILTEX™ CONTOUR PROFILE™ Expanders/Implants

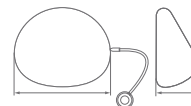

Temp. Volume	Min. Volume	NOMINAL FILL			MAXIMUM FILL			Catalog #		
		Final Volume	Width	Height	Proj.	Final Volume	Width		Height	Proj.
275 cc	235 cc	275 cc	11,5 cm	9,5 cm	5,1 cm	330 cc	11,1 cm	9,4 cm	6,3 cm	354-2511
350 cc	300 cc	350 cc	12,3 cm	10,5 cm	5,3 cm	420 cc	11,9 cm	10,1 cm	6,9 cm	354-2512
450 cc	380 cc	450 cc	13,2 cm	11,0 cm	6,1 cm	540 cc	12,7 cm	11,0 cm	7,5 cm	354-2513
550 cc	470 cc	550 cc	14,0 cm	11,9 cm	6,4 cm	660 cc	13,7 cm	11,9 cm	7,9 cm	354-2514
650 cc	550 cc	650 cc	15,0 cm	12,7 cm	6,6 cm	780 cc	14,5 cm	12,5 cm	8,2 cm	354-2515

Sterile Saline Breast Implant Sizers[†]Round Saline Breast Implant Sizers,
Moderate Profile

NOMINAL FILL			MAXIMUM FILL			Catalog #
Volume	Diameter	Projection	Volume	Diameter	Projection	
125 cc	9,5 cm	3,0 cm	150 cc	9,1 cm	3,4 cm	351-125SZ
175 cc	10,6 cm	3,3 cm	200 cc	10,0 cm	3,9 cm	351-175SZ
225 cc	11,5 cm	3,5 cm	250 cc	10,9 cm	4,0 cm	351-225SZ
275 cc	12,3 cm	3,7 cm	300 cc	11,7 cm	4,2 cm	351-275SZ
325 cc	13,0 cm	3,8 cm	375 cc	12,3 cm	4,5 cm	351-325SZ
375 cc	13,6 cm	4,0 cm	425 cc	12,8 cm	4,8 cm	351-375SZ
425 cc	14,2 cm	4,1 cm	475 cc	13,5 cm	4,9 cm	351-425SZ
475 cc	14,8 cm	4,2 cm	525 cc	14,2 cm	4,9 cm	351-475SZ

Round Saline Breast Implant Sizers,
Moderate Plus Profile

NOMINAL FILL			MAXIMUM FILL			Catalog #
Volume	Diameter	Projection	Volume	Diameter	Projection	
175 cc	9,5 cm	3,5 cm	210 cc	9,3 cm	4,2 cm	351-2175SZ
200 cc	10,0 cm	3,7 cm	240 cc	9,7 cm	4,4 cm	351-2200SZ
225 cc	10,4 cm	3,8 cm	270 cc	10,1 cm	4,6 cm	351-2225SZ
250 cc	10,8 cm	4,0 cm	300 cc	10,5 cm	4,7 cm	351-2250SZ
275 cc	11,0 cm	4,1 cm	330 cc	10,8 cm	4,9 cm	351-2275SZ
300 cc	11,5 cm	4,3 cm	360 cc	11,2 cm	5,0 cm	351-2300SZ
325 cc	11,9 cm	4,4 cm	390 cc	11,5 cm	5,2 cm	351-2325SZ
350 cc	12,1 cm	4,5 cm	420 cc	11,7 cm	5,3 cm	351-2350SZ
375 cc	12,3 cm	4,6 cm	450 cc	12,0 cm	5,4 cm	351-2375SZ
400 cc	12,6 cm	4,7 cm	480 cc	12,3 cm	5,5 cm	351-2400SZ
425 cc	12,9 cm	4,8 cm	510 cc	12,5 cm	5,6 cm	351-2425SZ
450 cc	13,0 cm	4,9 cm	540 cc	12,8 cm	5,7 cm	351-2450SZ
475 cc	13,3 cm	5,0 cm	570 cc	13,0 cm	5,8 cm	351-2475SZ
500 cc	13,6 cm	5,1 cm	600 cc	13,2 cm	5,9 cm	351-2500SZ
550 cc	14,0 cm	5,3 cm	660 cc	13,7 cm	6,1 cm	351-2550SZ
600 cc	14,5 cm	5,5 cm	720 cc	14,1 cm	6,3 cm	351-2600SZ
650 cc	14,8 cm	5,6 cm	780 cc	14,4 cm	6,5 cm	351-2650SZ
700 cc	15,2 cm	5,8 cm	840 cc	14,8 cm	6,6 cm	351-2700SZ
750 cc	15,6 cm	5,9 cm	900 cc	15,1 cm	6,8 cm	351-2750SZ
800 cc	16,1 cm	6,0 cm	960 cc	15,5 cm	7,0 cm	351-2800SZ

Note: Individual implant dimensions may vary slightly in products of this type.
Not all units will conform exactly to the dimensions noted above

Sterile Saline Implant Sizers[†] CONT'D

Round Saline Breast Implant Sizers, High Profile



NOMINAL FILL			MAXIMUM FILL			Catalog #
Volume	Diameter	Projection	Volume	Diameter	Projection	
190 cc	9,3 cm	4,1 cm	225 cc	9,1 cm	5,1 cm	351-3190SZ
230 cc	10,0 cm	4,3 cm	275 cc	9,8 cm	5,5 cm	351-3230SZ
270 cc	10,4 cm	4,6 cm	325 cc	10,2 cm	5,8 cm	351-3270SZ
290 cc	10,8 cm	4,7 cm	350 cc	10,5 cm	5,9 cm	351-3290SZ
310 cc	11,0 cm	4,8 cm	375 cc	10,7 cm	6,0 cm	351-3310SZ
330 cc	11,3 cm	4,8 cm	400 cc	11,0 cm	6,2 cm	351-3330SZ
380 cc	11,7 cm	5,2 cm	450 cc	11,4 cm	6,4 cm	351-3380SZ
420 cc	12,0 cm	5,4 cm	500 cc	11,7 cm	6,7 cm	351-3420SZ
500 cc	12,8 cm	5,6 cm	600 cc	12,4 cm	7,1 cm	351-3500SZ
630 cc	13,8 cm	5,9 cm	750 cc	13,4 cm	7,4 cm	351-3630SZ

CONTOUR PROFILE™ Saline Breast Implant Sizers, High Profile

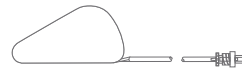

Volume	Width	Height	Projection	Catalog #
275 + 25 cc	11,5 cm	9,5 cm	5,1 cm	351-0711SZ
350 + 50 cc	12,3 cm	10,5 cm	5,3 cm	351-0712SZ
450 + 50 cc	13,2 cm	11,0 cm	6,1 cm	351-0713SZ
550 + 50 cc	14,0 cm	11,9 cm	6,4 cm	351-0714SZ
650 + 75 cc	15,0 cm	12,7 cm	6,6 cm	351-0715SZ

Accessories

Injection Port Detector

Description	Catalog #
CENTERSCOPE™ Magnetic Detection Device	350-4402

Injection Dome

Description	Catalog #
Dome Pack Set	350-DOMPK

Can be used with SPECTRA™ Adjustable Gel Breast Implant, SPECTRUM™ Post-Operatively Adjustable Saline Breast Implant, Round BECKER™ Expander/Breast Implant, and Smooth Tissue Expanders.

Important Safety Information

MENTOR® Breast Implants are indicated for breast augmentation, in women who are at least 18 years old, or for breast reconstruction. Breast implant surgery should not be performed in women with active infection anywhere in their body, with existing cancer or pre-cancer of their breast(s) who have not received adequate treatment for those conditions or who are pregnant or nursing.

There are risks associated with breast implant surgery. Breast implants are not lifetime devices and breast implantation is not necessarily a one-time surgery.

The most common complications with MENTOR® MemoryGel™ Breast Implants and PERTHESE™ Breast Implants include re-operation, implant removal, capsular contracture, asymmetry, and breast pain. A lower risk of complication is implant rupture, which is most often silent. The health consequences of a ruptured silicone gel-filled breast implant have not been fully established. Screenings such as mammography, MRI, or ultrasound are recommended after initial implant surgery to assist in detecting implant rupture.

The most common complications with MENTOR® Saline-Filled Implants include re-operation, implant removal, capsular contracture, wrinkling, deflation, asymmetry, and breast pain.

MENTOR® CONTOUR PROFILE™ Tissue Expanders and MENTOR® Smooth Round Tissue Expanders with Remote Dome are used for breast reconstruction following mastectomy. These expanders are intended for temporary subcutaneous or submuscular implantation and are not intended for use beyond six months. CONTOUR PROFILE™ Tissue Expanders are devices that contain magnetic injection domes and are NOT MRI compatible. Do not use the CONTOUR PROFILE™ Tissue Expander in patients where an MRI may be needed. DO NOT use the CONTOUR PROFILE™ Tissue Expander in patients that have a previously implanted device that could be affected by a magnetic field. The device could be moved by the MRI causing pain or displacement, potentially resulting in a revision surgery. The incidence of extrusion of the expander has been shown to increase when the expander has been placed in injured areas: scarred, heavily irradiated or burned tissue, crushed bone areas or where severe surgical reduction of the area has previously been performed.

Your patient needs to be informed and understand the risks and benefits of breast implants, and provided with an opportunity to consult with you prior to deciding on surgery.

For detailed indications, contraindications, warning and precautions associated with the use of all MENTOR® Implantable Devices, please refer to the Product Insert Data Sheet provided with each product, or review the Important Safety Information provided at www.mentorwllc.eu

Our Credo

We believe our first responsibility is to the doctors, nurses and patients, to mothers and fathers and all others who use our products and services. In meeting their needs everything we do must be of high quality. We must constantly strive to reduce our costs in order to maintain reasonable prices. Customers' orders must be serviced promptly and accurately. Our suppliers and distributors must have an opportunity to make a fair profit.

We are responsible to our employees, the men and women who work with us throughout the world. Everyone must be considered as an individual. We must respect their dignity and recognize their merit. They must have a sense of security in their jobs. Compensation must be fair and adequate, and working conditions clean, orderly and safe. We must be mindful of ways to help our employees fulfill their family responsibilities. Employees must feel free to make suggestions and complaints. There must be equal opportunity for employment, development and advancement for those qualified. We must provide competent management, and their actions must be just and ethical.

We are responsible to the communities in which we live and work and to the world community as well. We must be good citizens – support good works and charities and bear our fair share of taxes. We must encourage civic improvements and better health and education. We must maintain in good order the property we are privileged to use, protecting the environment and natural resources.

Our final responsibility is to our stockholders. Business must make a sound profit. We must experiment with new ideas. Research must be carried on, innovative programs developed and mistakes paid for. New equipment must be purchased, new facilities provided and new products launched. Reserves must be created to provide for adverse times. When we operate according to these principles, the stockholders should realize a fair return.



A division of Johnson & Johnson Medical Limited
Pinewood Campus, Nine Mile Ride, Wokingham
Berkshire, RG40 3EW
Customer Service 0800 973 082
contact@medgb.jnj.com
www.mentormedical.co.uk

IMPLANT CATALOGUE



PERTHESE™
BREAST IMPLANTS



www.mentormedical.co.uk
Customer Service 0800 973 082
contact@medgb.jnj.com

NOT FOR DISTRIBUTION IN USA
APPROVED FOR EMEA REGION
© Mentor Worldwide LLC 2012 0907007 Rev C



Based on the high level of manufacturing standards and quality testing, Perouse Plastique was the first French implant manufacturer given the authorization to sell silicone gel products into the local market after a ban period of several years. The company launched its trademark **PERTHESE™ Breast Implant in 1990.**

During the following years, Perouse Plastique was not only able to continuously strengthen its market position in France but also in many other EU countries as well as in Latin America. With the acquisition through Mentor in 2007, more surgeons worldwide now have the opportunity to access this unique range of products adapted to the needs of medical professionals AND their patients in both Aesthetic and Reconstructive procedures.

The **PERTHESE™ Breast Implant** is a sterile gel-filled implant made of a trilaminar silicone envelope. The envelope consists of an internal and external layer made with a medical grade silicone elastomer and an intermediate barrier layer designed to reduce gel bleed.

The **PERTHESE™ Implant range** is available in two lines of breast implants:

PERTHESE™ Breast Implants

Round breast implants filled with a soft and cohesive silicone gel, available either with a micro-textured surface or with a smooth surface.

Product Profile	Micro-textured	Smooth
TX, Low Profile	X	
MX, Moderate Profile	X	
MP, Moderate Plus Profile	X	
540, High Profile	X	
550, Ultra High Profile	X	
700T, Low Profile		X
510T, High Profile		X

PERTHESE™ Esthea Breast Implants

Anatomical breast implants filled with a cohesive silicone gel with a micro-textured surface, available in different base shapes.

Product Profile	Micro-textured	Smooth
ELP-EHP-ESHP	X	
AX	X	
EFP	X	
EMP-EMHP	X	

All **PERTHESE™ Silicone Gel-filled Breast Implants** are covered by **PERTHESE Quality Assurance Program warranty** or **PatientCare Promise limited warranty†**

† In case of eligibility, depending on the date of surgery, the implant will fall under one of the above warranties.

CONTENTS

PERTHESE™ Breast Implants Cohesive Silicone Gel Breast Implants, Round Shapes. 1

PERTHESE™ Breast Implants TX, Low Profile, Micro-Textured
PERTHESE™ Breast Implants MX, Moderate Profile, Micro-Textured
PERTHESE™ Breast Implants MP, Moderate Plus Profile, Micro-Textured
PERTHESE™ Breast Implants 540, High Profile, Micro-Textured
PERTHESE™ Breast Implants 550, Ultra High Profile, Micro-Textured
PERTHESE™ Breast Implants 700T, Low Profile, Smooth
PERTHESE™ Breast Implants 510T, High Profile, Smooth
PERTHESE™ Breast Implants Summary Chart

PERTHESE™ Esthea Breast Implants Cohesive Silicone Gel Breast Implants, Anatomical Shapes. 7

PERTHESE™ Esthea Breast Implants ELP - EHP - ESHP, Micro-Textured
PERTHESE™ Esthea Breast Implants AX, Micro-Textured
PERTHESE™ Esthea Breast Implants EFP, Micro-Textured
PERTHESE™ Esthea Breast Implants EMP - EMHP, Micro-Textured
MENTOR® CPX4™ Tissue Expanders / PERTHESE™ Esthea Breast Implants Sizing Guide - Two-Stage Breast Reconstruction

PERTHESE™ Sterile Silicone Breast Implant Sizers, Round Shapes 11

PERTHESE™ Breast Implant Sizers TX, Low Profile, Micro-Textured
PERTHESE™ Breast Implant Sizers MX, Moderate Profile, Micro-Textured
PERTHESE™ Breast Implant Sizers 540, High Profile, Micro-Textured

PERTHESE™ Sterile Inflatable Breast Implant Sizers, Round Shapes 13

PERTHESE™ Breast Implant Sizers TX, Low Profile, Micro-Textured
PERTHESE™ Breast Implant Sizers MX, Moderate Profile, Micro-Textured
PERTHESE™ Breast Implant Sizers 540, High Profile, Micro-Textured

PERTHESE™ Esthea Sterile Silicone Breast Implant Sizers, Anatomical Shapes. 15

PERTHESE™ Breast Esthea Implant Sizers ELP - EHP - ESHP, Micro-Textured
PERTHESE™ Breast Esthea Implant Sizers AX, Micro-Textured
PERTHESE™ Breast Esthea Implant Sizers EMP, Micro-Textured

PERTHESE™ Esthea Sterile Inflatable
Breast Implant Sizers, Anatomical Shapes. 17

PERTHESE™ Breast Implant Sizers ELP - EHP - ESHP, Micro-Textured
PERTHESE™ Breast Implant Sizers AX, Micro-Textured
PERTHESE™ Breast Implant Sizers EMP, Micro-Textured

Important Safety Information. 19

Contact Information 20

PERTHESE™ BREAST IMPLANTS

Cohesive Silicone Gel Breast Implants, Round Shapes

PERTHESE™ Breast Implants TX, Low Profile, Micro-Textured



Volume	Diameter	Projection	Catalog #
100 cc	9,1 cm	2,2 cm	TX 100
125 cc	9,7 cm	2,4 cm	TX 125
150 cc	10,2 cm	2,6 cm	TX 150
170 cc	10,8 cm	2,7 cm	TX 170
185 cc	11,1 cm	2,8 cm	TX 185
200 cc	11,4 cm	2,9 cm	TX 200
220 cc	11,8 cm	2,9 cm	TX 220
240 cc	12,2 cm	3,0 cm	TX 240
260 cc	12,3 cm	3,1 cm	TX 260
280 cc	12,5 cm	3,2 cm	TX 280
300 cc	12,8 cm	3,2 cm	TX 300
325 cc	13,1 cm	3,3 cm	TX 325
350 cc	13,5 cm	3,4 cm	TX 350

PERTHESE™ Breast Implants MX, Moderate Profile, Micro-Textured

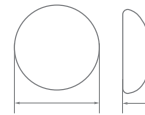

Volume	Diameter	Projection	Catalog #
100 cc	8,7 cm	2,8 cm	MX 100
125 cc	9,2 cm	3,0 cm	MX 125
150 cc	9,9 cm	3,2 cm	MX 150
175 cc	10,4 cm	3,3 cm	MX 175
200 cc	11,0 cm	3,4 cm	MX 200
225 cc	11,5 cm	3,5 cm	MX 225
250 cc	12,0 cm	3,6 cm	MX 250
275 cc	12,2 cm	3,7 cm	MX 275
300 cc	12,5 cm	3,8 cm	MX 300
325 cc	12,8 cm	4,0 cm	MX 325
350 cc	13,0 cm	4,2 cm	MX 350
375 cc	13,2 cm	4,4 cm	MX 375
400 cc	13,5 cm	4,5 cm	MX 400
450 cc	13,9 cm	4,6 cm	MX 450
500 cc	14,2 cm	5,0 cm	MX 500
550 cc	14,5 cm	5,2 cm	MX 550
600 cc	14,9 cm	5,4 cm	MX 600
650 cc	15,2 cm	5,5 cm	MX 650
700 cc	15,6 cm	5,6 cm	MX 700
800 cc	16,1 cm	6,0 cm	MX 800

Note: Individual implant dimensions may vary slightly in products of this type.

Not all units will conform exactly to the dimensions noted above

Cohesive Silicone Gel Breast Implants,
Round Shapes CONT'D

**PERTHESE™ Breast Implants MP,
Moderate Plus Profile, Micro-Textured**

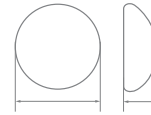

Volume	Diameter	Projection	Catalog #
115 cc	8,7 cm	3,1 cm	MP 115
135 cc	9,2 cm	3,2 cm	MP 135
165 cc	9,9 cm	3,4 cm	MP 165
190 cc	10,5 cm	3,6 cm	MP 190
225 cc	11,0 cm	3,9 cm	MP 225
260 cc	11,6 cm	4,1 cm	MP 260
305 cc	12,1 cm	4,4 cm	MP 305
320 cc	12,3 cm	4,5 cm	MP 320
345 cc	12,5 cm	4,6 cm	MP 345
380 cc	12,7 cm	4,9 cm	MP 380
410 cc	13,0 cm	5,0 cm	MP 410
440 cc	13,2 cm	5,3 cm	MP 440
475 cc	13,5 cm	5,4 cm	MP 475
510 cc	13,8 cm	5,5 cm	MP 510
580 cc	14,3 cm	5,6 cm	MP 580
635 cc	14,4 cm	5,9 cm	MP 635
685 cc	14,9 cm	6,1 cm	MP 685
735 cc	15,2 cm	6,3 cm	MP 735
800 cc	15,7 cm	6,4 cm	MP 800
910 cc	16,2 cm	6,8 cm	MP 910

**PERTHESE™ Breast Implants 540,
High Profile, Micro-Textured**

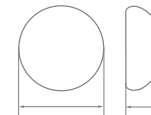

Volume	Diameter	Projection	Catalog #
75 cc	8,1 cm	2,3 cm	540-075
100 cc	8,2 cm	3,0 cm	540-100
125 cc	8,8 cm	3,2 cm	540-125
150 cc	9,2 cm	3,4 cm	540-150
175 cc	9,9 cm	3,6 cm	540-175
200 cc	10,1 cm	3,8 cm	540-200
230 cc	10,4 cm	4,0 cm	540-230
260 cc	11,0 cm	4,3 cm	540-260
280 cc	11,1 cm	4,4 cm	540-280
300 cc	11,2 cm	4,5 cm	540-300
325 cc	11,7 cm	4,6 cm	540-325
350 cc	11,9 cm	4,8 cm	540-350
380 cc	12,0 cm	4,9 cm	540-380
400 cc	12,1 cm	4,9 cm	540-400
440 cc	12,7 cm	5,3 cm	540-440
500 cc	13,2 cm	5,4 cm	540-500
550 cc	13,25 cm	5,9 cm	540-550
600 cc	13,8 cm	6,0 cm	540-600
650 cc	14,2 cm	6,1 cm	540-650
850 cc	15,5 cm	6,7 cm	540-850

PERTHESE™ BREAST IMPLANTS

Cohesive Silicone Gel Breast Implants, Round Shapes CONT'D

PERTHESE™ Breast Implants 550, Ultra High Profile, Micro-Textured



Volume	Diameter	Projection	Catalog #
95 cc	7,5 cm	3,5 cm	550-095
125 cc	8,2 cm	3,8 cm	550-125
150 cc	8,8 cm	3,9 cm	550-150
160 cc	9,0 cm	4,0 cm	550-160
175 cc	9,2 cm	4,1 cm	550-175
195 cc	9,5 cm	4,2 cm	550-195
215 cc	9,7 cm	4,3 cm	550-215
235 cc	10,1 cm	4,5 cm	550-235
265 cc	10,4 cm	4,7 cm	550-265
285 cc	10,8 cm	4,7 cm	550-285
315 cc	11,1 cm	4,9 cm	550-315
330 cc	11,2 cm	5,1 cm	550-330
345 cc	11,3 cm	5,2 cm	550-345
390 cc	11,7 cm	5,4 cm	550-390
410 cc	12,0 cm	5,4 cm	550-410
425 cc	12,1 cm	5,5 cm	550-425
445 cc	12,2 cm	5,7 cm	550-445
485 cc	12,6 cm	6,0 cm	550-485
530 cc	12,9 cm	6,0 cm	550-530
580 cc	13,4 cm	6,1 cm	550-580
630 cc	13,6 cm	6,3 cm	550-630
705 cc	14,1 cm	6,7 cm	550-705

Note: Individual implant dimensions may vary slightly in products of this type.
Not all units will conform exactly to the dimensions noted above

Cohesive Silicone Gel Breast Implants, Round Shapes CONT'D

PERTHESE™ Breast Implants 700T, Low Profile, Smooth



Volume	Diameter	Projection	Catalog #
120 cc	9,7 cm	2,4 cm	700 T-120
140 cc	10,3 cm	2,4 cm	700 T-140
160 cc	10,8 cm	2,5 cm	700 T-160
180 cc	11,2 cm	2,6 cm	700 T-180
200 cc	11,2 cm	2,8 cm	700 T-200
220 cc	11,9 cm	2,8 cm	700 T-220
240 cc	12,1 cm	2,9 cm	700 T-240
260 cc	12,2 cm	3,1 cm	700 T-260
280 cc	12,6 cm	3,2 cm	700 T-280
300 cc	12,8 cm	3,2 cm	700 T-300
325 cc	13,1 cm	3,3 cm	700 T-325
350 cc	13,5 cm	3,3 cm	700 T-350

PERTHESE™ Breast Implants 510T, High Profile, Smooth

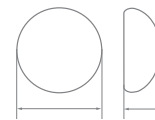

Volume	Diameter	Projection	Catalog #
80 cc	8,1 cm	2,5 cm	510 T-080
100 cc	9,1 cm	2,7 cm	510 T-100
120 cc	9,3 cm	2,9 cm	510 T-120
140 cc	9,6 cm	3,3 cm	510 T-140
160 cc	9,6 cm	3,4 cm	510 T-160
180 cc	10,0 cm	3,6 cm	510 T-180
200 cc	10,2 cm	3,7 cm	510 T-200
220 cc	10,7 cm	3,9 cm	510 T-220
240 cc	10,7 cm	4,2 cm	510 T-240
270 cc	11,0 cm	4,3 cm	510 T-270
300 cc	11,4 cm	4,4 cm	510 T-300
340 cc	11,7 cm	4,6 cm	510 T-340
380 cc	11,9 cm	4,8 cm	510 T-380
400 cc	12,2 cm	5,0 cm	510 T-400
450 cc	12,6 cm	5,3 cm	510 T-450
500 cc	13,3 cm	5,5 cm	510 T-500

PERTHESE™ BREAST IMPLANTS

PERTHESE™ Breast Implants Summary Chart

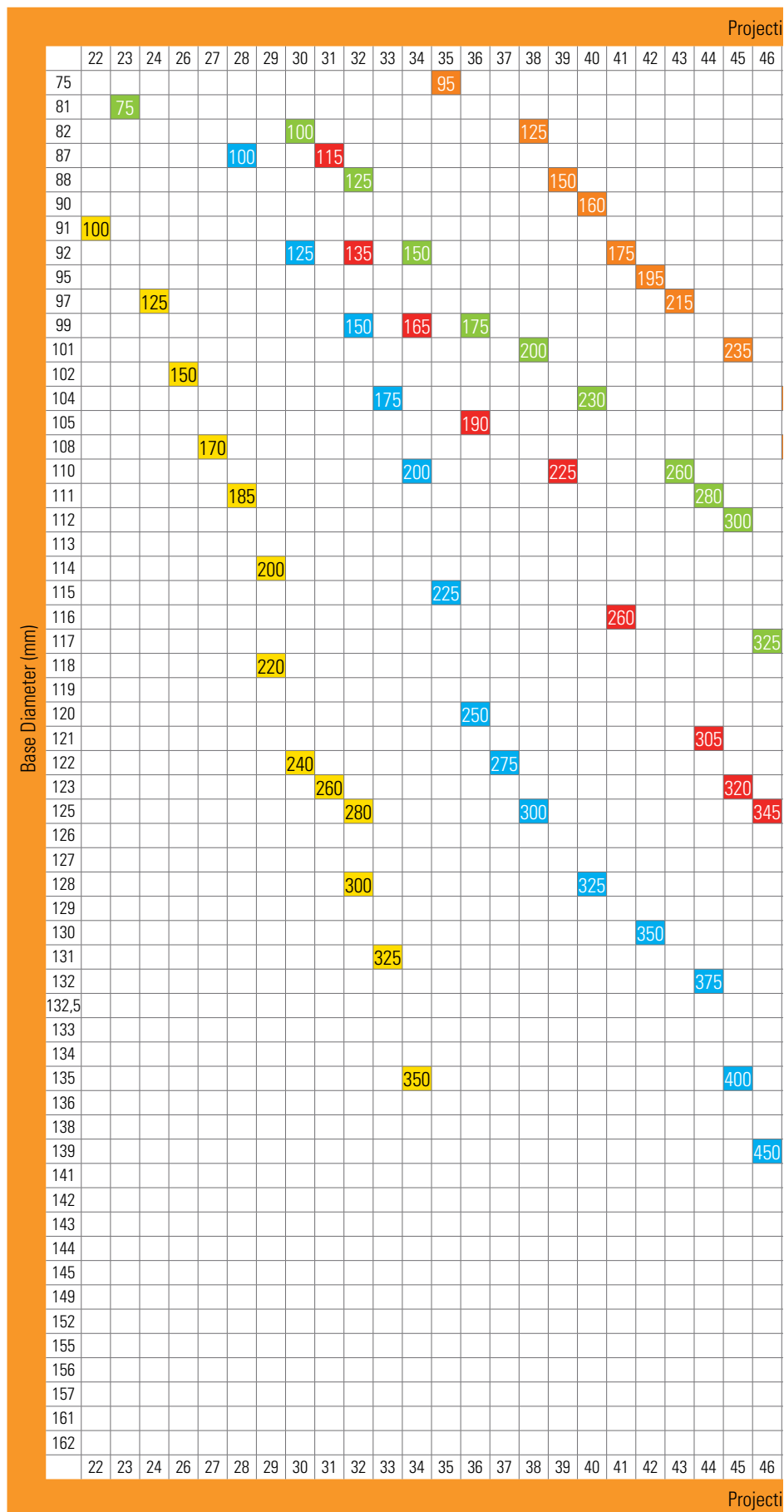

Note: Individual implant dimensions may vary slightly in products of this type.
Not all units will conform exactly to the dimensions noted above

PERTHESE™ BREAST IMPLANTS

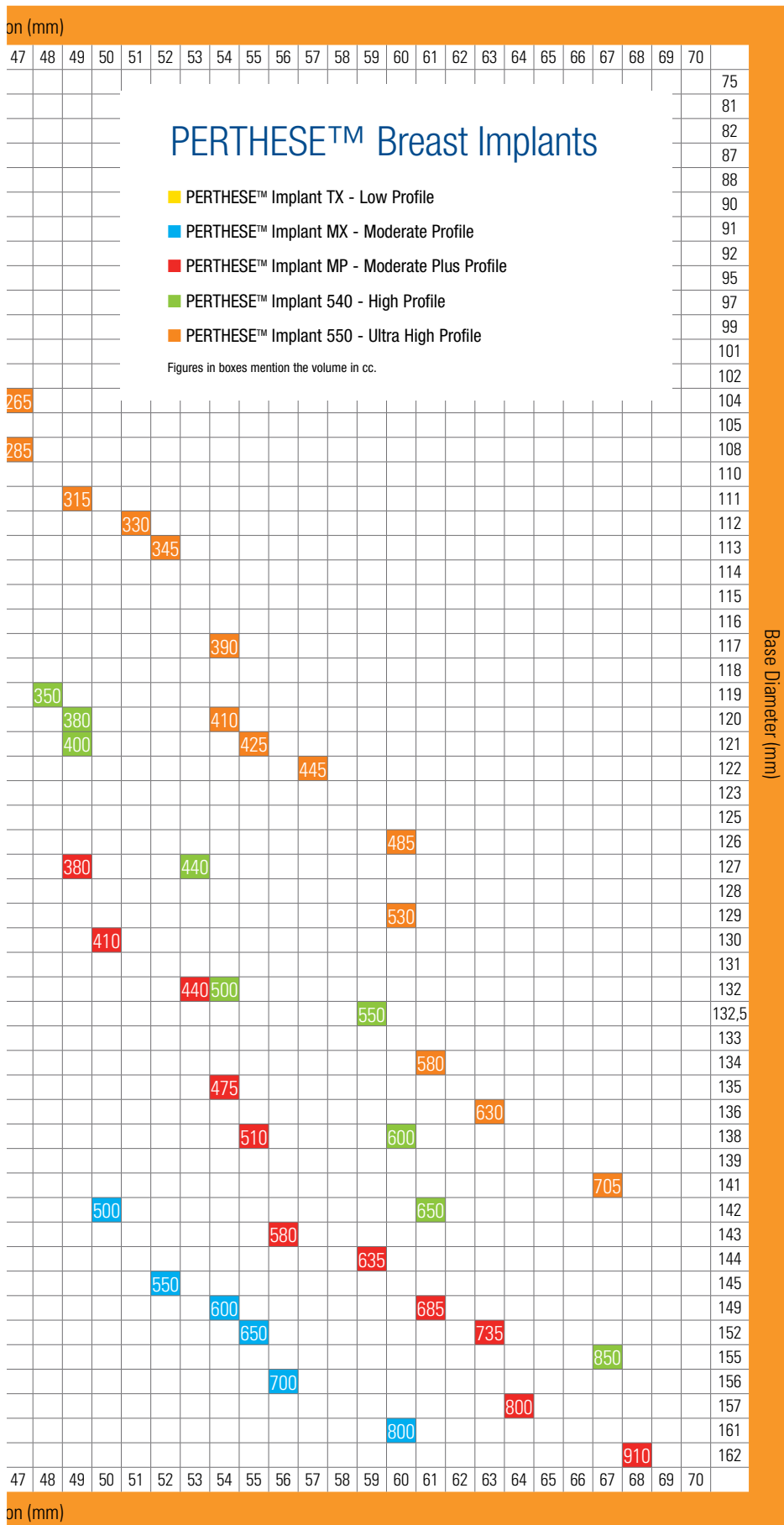

PERTHESE™ ESTHEA BREAST IMPLANTS

Cohesive Silicone Gel Breast Implants, Anatomical Shapes

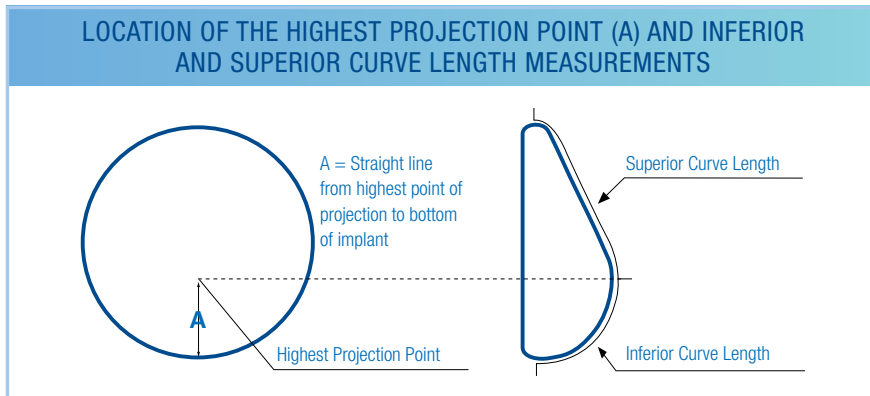

PERTHESE™ Esthea Breast Implants ELP - EHP - ESHP, Micro-Textured



Volume	Width	Height	Projection	A	Inferior Curve Length	Superior Curve Length	Catalog #
190 cc	10,0 cm	12,5 cm	3,5 cm	3,6 cm	4,8 cm	9,2 cm	ELP 190
225 cc	10,0 cm	12,5 cm	4,0 cm	3,6 cm	5,6 cm	9,5 cm	EHP 225
235 cc	10,0 cm	12,5 cm	4,6 cm	3,5 cm	5,7 cm	9,5 cm	ESHP 235
240 cc	11,1 cm	13,8 cm	3,6 cm	3,7 cm	5,0 cm	10,2 cm	ELP 240
275 cc	11,1 cm	13,8 cm	4,2 cm	3,7 cm	5,8 cm	10,6 cm	EHP 275
295 cc	11,1 cm	13,8 cm	4,8 cm	3,7 cm	6,1 cm	10,6 cm	ESHP 295
270 cc	11,7 cm	14,0 cm	3,9 cm	4,1 cm	5,5 cm	10,3 cm	ELP 270
325 cc	11,7 cm	14,0 cm	4,7 cm	4,1 cm	6,4 cm	10,6 cm	EHP 325
355 cc	11,7 cm	14,0 cm	5,3 cm	4,0 cm	6,8 cm	10,7 cm	ESHP 355
310 cc	12,3 cm	14,4 cm	4,2 cm	4,3 cm	6,0 cm	10,4 cm	ELP 310
375 cc	12,3 cm	14,4 cm	5,1 cm	4,3 cm	6,8 cm	10,8 cm	EHP 375
415 cc	12,3 cm	14,4 cm	5,6 cm	4,3 cm	7,2 cm	10,9 cm	ESHP 415
360 cc	12,6 cm	14,8 cm	4,5 cm	4,7 cm	6,4 cm	10,5 cm	ELP 360
425 cc	12,6 cm	14,8 cm	5,4 cm	4,7 cm	7,4 cm	10,9 cm	EHP 425
475 cc	12,6 cm	14,8 cm	5,9 cm	4,7 cm	7,9 cm	11,1 cm	ESHP 475

PERTHESE™ Esthea Breast Implants AX, Micro-Textured

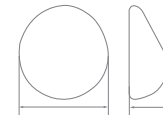

Volume	Width	Height	Projection	A	Inferior Curve Length	Superior Curve Length	Catalog #
190 cc	10,6 cm	10,8 cm	4,3 cm	3,7 cm	5,8 cm	7,8 cm	AX 190
210 cc	10,9 cm	11,2 cm	4,4 cm	3,8 cm	6,0 cm	8,2 cm	AX 210
240 cc	11,5 cm	12,2 cm	4,6 cm	3,9 cm	6,1 cm	8,8 cm	AX 240
260 cc	11,9 cm	12,5 cm	4,8 cm	4,0 cm	6,3 cm	9,1 cm	AX 260
285 cc	12,1 cm	12,8 cm	4,9 cm	4,1 cm	6,4 cm	9,4 cm	AX 285
300 cc	12,6 cm	13,2 cm	4,9 cm	4,2 cm	6,6 cm	9,6 cm	AX 300
340 cc	12,9 cm	13,7 cm	4,9 cm	4,4 cm	6,9 cm	10,0 cm	AX 340
380 cc	13,3 cm	14,1 cm	5,0 cm	4,6 cm	7,2 cm	10,2 cm	AX 380
400 cc	13,6 cm	14,2 cm	5,1 cm	4,7 cm	7,4 cm	10,3 cm	AX 400
450 cc	13,9 cm	14,7 cm	5,2 cm	4,8 cm	7,5 cm	10,8 cm	AX 450
480 cc	14,5 cm	15,2 cm	5,3 cm	4,9 cm	7,7 cm	11,2 cm	AX 480
500 cc	14,9 cm	15,6 cm	5,3 cm	5,0 cm	7,9 cm	11,5 cm	AX 500

Note: Individual implant dimensions may vary slightly in products of this type.

Not all units will conform exactly to the dimensions noted above

Cohesive Silicone Gel Breast Implants,
Anatomical Shapes CONT'D

PERTHESE™ Esthea Breast Implants
EFP, Micro-Textured

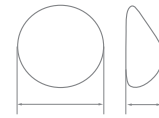

Volume	Width	Height	Projection	A	Inferior Curve Length	Superior Curve Length	Catalog #
95 cc	8,1 cm	7,5 cm	3,4 cm	2,7 cm	4,2 cm	5,4 cm	EFP 095
115 cc	8,6 cm	8,1 cm	3,6 cm	3,0 cm	4,6 cm	5,8 cm	EFP 115
140 cc	9,2 cm	8,5 cm	3,8 cm	3,2 cm	5,0 cm	6,1 cm	EFP 140
180 cc	10,2 cm	9,2 cm	4,1 cm	3,5 cm	5,4 cm	6,6 cm	EFP 180
210 cc	10,7 cm	9,7 cm	4,3 cm	3,7 cm	5,7 cm	6,9 cm	EFP 210
250 cc	11,2 cm	10,2 cm	4,5 cm	3,9 cm	6,1 cm	7,3 cm	EFP 250
285 cc	11,7 cm	10,7 cm	4,7 cm	4,1 cm	6,4 cm	7,7 cm	EFP 285
325 cc	12,2 cm	11,3 cm	4,9 cm	4,2 cm	6,6 cm	8,1 cm	EFP 325
370 cc	12,7 cm	11,8 cm	5,1 cm	4,4 cm	6,9 cm	8,4 cm	EFP 370
415 cc	13,1 cm	12,2 cm	5,3 cm	4,7 cm	7,3 cm	8,7 cm	EFP 415
470 cc	13,6 cm	12,6 cm	5,5 cm	4,9 cm	7,7 cm	9,0 cm	EFP 470
520 cc	14,0 cm	13,1 cm	5,7 cm	5,1 cm	8,0 cm	9,4 cm	EFP 520
575 cc	14,6 cm	13,5 cm	5,9 cm	5,3 cm	8,3 cm	9,6 cm	EFP 575
640 cc	15,1 cm	14,0 cm	6,1 cm	5,6 cm	8,8 cm	9,9 cm	EFP 640
710 cc	15,5 cm	14,2 cm	6,3 cm	5,8 cm	9,1 cm	10,1 cm	EFP 710

PERTHESE™ Esthea Breast Implants
EMP - EMHP, Micro-Textured



Volume	Width	Height	Projection	A	Inferior Curve Length	Superior Curve Length	Catalog #
80 cc	8,1 cm	6,8 cm	3,2 cm	2,4 cm	3,7 cm	4,9 cm	EMP 080
90 cc	8,1 cm	6,8 cm	3,5 cm	2,4 cm	4,1 cm	5,2 cm	EMHP 090
100 cc	8,6 cm	7,3 cm	3,5 cm	2,7 cm	4,2 cm	5,3 cm	EMP 100
110 cc	8,6 cm	7,3 cm	3,8 cm	2,7 cm	4,6 cm	5,5 cm	EMHP 110
120 cc	9,2 cm	7,7 cm	3,6 cm	2,9 cm	4,5 cm	5,5 cm	EMP 120
130 cc	9,2 cm	7,7 cm	4,0 cm	2,9 cm	4,9 cm	5,8 cm	EMHP 130
145 cc	10,2 cm	8,5 cm	3,9 cm	3,2 cm	5,0 cm	6,1 cm	EMP 145
170 cc	10,2 cm	8,5 cm	4,3 cm	3,1 cm	5,3 cm	6,4 cm	EMHP 170
165 cc	10,7 cm	9,1 cm	4,0 cm	3,4 cm	5,3 cm	6,4 cm	EMP 165
195 cc	10,7 cm	9,1 cm	4,5 cm	3,3 cm	5,6 cm	6,8 cm	EMHP 195
200 cc	11,2 cm	9,6 cm	4,3 cm	3,6 cm	5,7 cm	6,8 cm	EMP 200
235 cc	11,2 cm	9,6 cm	4,7 cm	3,5 cm	5,9 cm	7,2 cm	EMHP 235
230 cc	11,7 cm	10,1 cm	4,5 cm	3,8 cm	6,0 cm	7,2 cm	EMP 230
270 cc	11,7 cm	10,1 cm	4,9 cm	3,7 cm	6,3 cm	7,6 cm	EMHP 270
265 cc	12,2 cm	10,6 cm	4,6 cm	3,9 cm	6,1 cm	7,6 cm	EMP 265
320 cc	12,2 cm	10,6 cm	5,1 cm	3,9 cm	6,6 cm	7,9 cm	EMHP 320
305 cc	12,7 cm	11,1 cm	4,9 cm	4,1 cm	6,4 cm	7,9 cm	EMP 305
360 cc	12,7 cm	11,1 cm	5,3 cm	4,1 cm	6,9 cm	8,3 cm	EMHP 360
345 cc	13,1 cm	11,6 cm	5,0 cm	4,4 cm	6,8 cm	8,2 cm	EMP 345
405 cc	13,1 cm	11,6 cm	5,5 cm	4,3 cm	7,2 cm	8,6 cm	EMHP 405
390 cc	13,6 cm	12,0 cm	5,2 cm	4,6 cm	7,2 cm	8,5 cm	EMP 390
455 cc	13,6 cm	12,0 cm	5,7 cm	4,5 cm	7,6 cm	9,0 cm	EMHP 455
435 cc	14,0 cm	12,5 cm	5,5 cm	4,8 cm	7,5 cm	8,9 cm	EMP 435
490 cc	14,0 cm	12,5 cm	5,8 cm	4,3 cm	7,7 cm	9,6 cm	EMHP 490
475 cc	14,6 cm	13,0 cm	5,7 cm	4,9 cm	7,7 cm	9,2 cm	EMP 475
545 cc	14,6 cm	13,0 cm	6,0 cm	4,6 cm	8,0 cm	9,7 cm	EMHP 545
535 cc	15,1 cm	13,3 cm	5,9 cm	5,0 cm	8,1 cm	9,6 cm	EMP 535
625 cc	15,1 cm	13,3 cm	6,2 cm	5,0 cm	8,6 cm	9,9 cm	EMHP 625
585 cc	15,5 cm	13,6 cm	6,1 cm	5,2 cm	8,4 cm	9,8 cm	EMP 585
680 cc	15,5 cm	13,6 cm	6,4 cm	5,2 cm	8,9 cm	10,2 cm	EMHP 680

PERTHESE™ ESTHEA BREAST IMPLANTS

MENTOR® CONTOUR PROFILE™ Tissue Expanders / PERTHESE™ Esthea Breast Implants Sizing Guide -

STAGE 1

Selection of the MENTOR® CPX4™, CPX™4,
and CPX™4 with Suture Tabs Expander *

CPX™4 Expander, & CPX™4 w/Suture Tabs
Expander Styles 8100,9100
– Low Height

Vol.	Width	Height	Proj.	Catalog #
250 cc	11,4 cm	8,1 cm	6,1 cm	354-9111
350 cc	12,7 cm	9,4 cm	6,5 cm	354-9112
450 cc	14,0 cm	10,2 cm	7,1 cm	354-9113
550 cc	15,0 cm	10,9 cm	7,4 cm	354-9114
650 cc	15,7 cm	11,2 cm	7,9 cm	354-9115
750 cc	16,5 cm	11,9 cm	8,1 cm	354-9116

CPX™4 Expander, & CPX™4 w/Suture Tabs
Expander Styles 8200,9200
– Medium Height

Vol.	Width	Height	Proj.	Catalog #
275 cc	10,7 cm	9,3 cm	6,2 cm	354-9211
350 cc	11,7 cm	10,0 cm	6,6 cm	354-9212
450 cc	12,7 cm	10,8 cm	7,0 cm	354-9213
550 cc	13,5 cm	11,7 cm	7,4 cm	354-9214
650 cc	14,6 cm	12,6 cm	7,6 cm	354-9215
800 cc	15,6 cm	13,3 cm	8,0 cm	354-9216

CPX™4 Expander, & CPX™4 w/Suture Tabs
Expander Styles 8300,9300
– Tall Height

Vol.	Width	Height	Proj.	Catalog #
250 cc	10,1 cm	10,7 cm	5,6 cm	354-9311
350 cc	11,3 cm	11,8 cm	6,0 cm	354-9312
450 cc	12,3 cm	12,9 cm	6,5 cm	354-9313
550 cc	13,2 cm	13,8 cm	6,9 cm	354-9314
650 cc	14,0 cm	14,6 cm	7,3 cm	354-9315
750 cc	14,6 cm	15,3 cm	7,6 cm	354-9316
850 cc	15,4 cm	15,9 cm	7,9 cm	354-9317

PERTHESE™ Esthea Breast Implants EMP

Vol.	Width	Height	Proj.	Catalog #
165 cc	10,7 cm	9,1 cm	4,0 cm	EMP165
200 cc	11,2 cm	9,6 cm	4,3 cm	EMP200
230 cc	11,7 cm	10,1 cm	4,5 cm	EMP230
265 cc	12,2 cm	10,6 cm	4,6 cm	EMP265
305 cc	12,7 cm	11,1 cm	4,9 cm	EMP305
345 cc	13,1 cm	11,6 cm	5,0 cm	EMP345
390 cc	13,6 cm	12,0 cm	5,2 cm	EMP390
435 cc	14,0 cm	12,5 cm	5,5 cm	EMP435
475 cc	14,6 cm	13,0 cm	5,7 cm	EMP475
535 cc	15,1 cm	13,3 cm	5,9 cm	EMP535
585 cc	15,5 cm	13,6 cm	6,1 cm	EMP585

PERTHESE™ Esthea Breast Implants EMP

Vol.	Width	Height	Proj.	Catalog #
120 cc	9,2 cm	7,7 cm	3,6 cm	EMP120
145 cc	10,2 cm	8,5 cm	3,9 cm	EMP145
165 cc	10,7 cm	9,1 cm	4,0 cm	EMP165
200 cc	11,2 cm	9,6 cm	4,3 cm	EMP200
230 cc	11,7 cm	10,1 cm	4,5 cm	EMP230
265 cc	12,2 cm	10,6 cm	4,6 cm	EMP265
305 cc	12,7 cm	11,1 cm	4,9 cm	EMP305
345 cc	13,1 cm	11,6 cm	5,0 cm	EMP345
390 cc	13,6 cm	12,0 cm	5,2 cm	EMP390
435 cc	14,0 cm	12,5 cm	5,5 cm	EMP435
475 cc	14,6 cm	13,0 cm	5,7 cm	EMP475
535 cc	15,1 cm	13,3 cm	5,9 cm	EMP535
585 cc	15,5 cm	13,6 cm	6,1 cm	EMP585

PERTHESE™ Esthea Breast Implants EFP

Vol.	Width	Height	Proj.	Catalog #
140 cc	9,2 cm	8,5 cm	3,8 cm	EFP140
180 cc	10,2 cm	9,2 cm	4,1 cm	EFP180
210 cc	10,7 cm	9,7 cm	4,3 cm	EFP210
250 cc	11,2 cm	10,2 cm	4,5 cm	EFP250
285 cc	11,7 cm	10,7 cm	4,7 cm	EFP285
325 cc	12,2 cm	11,3 cm	4,9 cm	EFP325
370 cc	12,7 cm	11,8 cm	5,1 cm	EFP370
415 cc	13,1 cm	12,2 cm	5,3 cm	EFP415
470 cc	13,6 cm	12,6 cm	5,5 cm	EFP470
520 cc	14,0 cm	13,1 cm	5,7 cm	EFP520
575 cc	14,6 cm	13,5 cm	5,9 cm	EFP575
640 cc	15,1 cm	14,0 cm	6,1 cm	EFP640
710 cc	15,5 cm	14,2 cm	6,3 cm	EFP710

Two-Stage Breast Reconstruction

STAGE 2

Selection of PERTHESE™ Esthea Implant to use as a long-term implant

PERTHESE™ Esthea Breast Implants EMHP

Vol.	Width	Height	Proj.	Catalog #
195 cc	10,7 cm	9,1 cm	4,5 cm	EMHP195
235 cc	11,2 cm	9,6 cm	4,7 cm	EMHP235
270 cc	11,7 cm	10,1 cm	4,9 cm	EMHP270
320 cc	12,2 cm	10,6 cm	5,1 cm	EMHP320
360 cc	12,7 cm	11,1 cm	5,3 cm	EMHP360
405 cc	13,1 cm	11,6 cm	5,5 cm	EMHP405
455 cc	13,6 cm	12,0 cm	5,7 cm	EMHP455
490 cc	14,0 cm	12,5 cm	5,8 cm	EMHP490
545 cc	14,6 cm	13,0 cm	6,0 cm	EMHP545
625 cc	15,1 cm	13,3 cm	6,2 cm	EMHP625
680 cc	15,5 cm	13,6 cm	6,4 cm	EMHP680

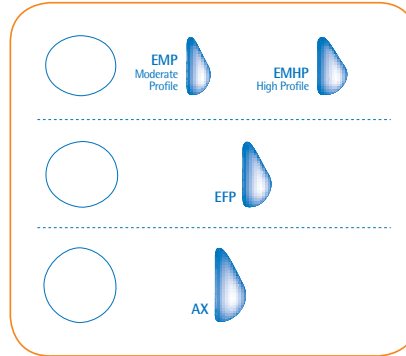

PERTHESE™ Esthea Breast Implants EMHP

Vol.	Width	Height	Proj.	Catalog #
130 cc	9,2 cm	7,7 cm	4,0 cm	EMHP130
170 cc	10,2 cm	8,5 cm	4,3 cm	EMHP170
195 cc	10,7 cm	9,1 cm	4,5 cm	EMHP195
235 cc	11,2 cm	9,6 cm	4,7 cm	EMHP235
270 cc	11,7 cm	10,1 cm	4,9 cm	EMHP270
320 cc	12,2 cm	10,6 cm	5,1 cm	EMHP320
360 cc	12,7 cm	11,1 cm	5,3 cm	EMHP360
405 cc	13,1 cm	11,6 cm	5,5 cm	EMHP405
455 cc	13,6 cm	12,0 cm	5,7 cm	EMHP455
490 cc	14,0 cm	12,5 cm	5,8 cm	EMHP490
545 cc	14,6 cm	13,0 cm	6,0 cm	EMHP545
625 cc	15,1 cm	13,3 cm	6,2 cm	EMHP625
680 cc	15,5 cm	13,6 cm	6,4 cm	EMHP680

PERTHESE™ Esthea Breast Implants EFP

Vol.	Width	Height	Proj.	Catalog #
140 cc	9,2 cm	8,5 cm	3,8 cm	EFP140
180 cc	10,2 cm	9,2 cm	4,1 cm	EFP180
210 cc	10,7 cm	9,7 cm	4,3 cm	EFP210
250 cc	11,2 cm	10,2 cm	4,5 cm	EFP250
285 cc	11,7 cm	10,7 cm	4,7 cm	EFP285
325 cc	12,2 cm	11,3 cm	4,9 cm	EFP325
370 cc	12,7 cm	11,8 cm	5,1 cm	EFP370
415 cc	13,1 cm	12,2 cm	5,3 cm	EFP415
470 cc	13,6 cm	12,6 cm	5,5 cm	EFP470
520 cc	14,0 cm	13,1 cm	5,7 cm	EFP520
575 cc	14,6 cm	13,5 cm	5,9 cm	EFP575
640 cc	15,1 cm	14,0 cm	6,1 cm	EFP640
710 cc	15,5 cm	14,2 cm	6,3 cm	EFP710

PERTHESE™ Esthea Breast Implants AX

Vol.	Width	Height	Proj.	Catalog #
190 cc	10,6 cm	10,8 cm	4,3 cm	AX190
210 cc	10,9 cm	11,2 cm	4,4 cm	AX210
240 cc	11,5 cm	12,2 cm	4,6 cm	AX240
260 cc	11,9 cm	12,5 cm	4,8 cm	AX260
285 cc	12,1 cm	12,8 cm	4,9 cm	AX285
300 cc	12,6 cm	13,2 cm	4,9 cm	AX300
340 cc	12,9 cm	13,7 cm	4,9 cm	AX340
380 cc	13,3 cm	14,1 cm	5,0 cm	AX380
400 cc	13,6 cm	14,2 cm	5,1 cm	AX400
450 cc	13,9 cm	14,7 cm	5,2 cm	AX450
480 cc	14,5 cm	15,2 cm	5,3 cm	AX480
500 cc	14,9 cm	15,6 cm	5,3 cm	AX500

*PLEASE NOTE: The MENTOR® CPX4™ Tissue Expander Injection Dome is not MRI compatible. For detailed indications, contraindications, warning and precautions associated with the use of this device, please refer to the Product Insert Data Sheet.

Individual implant dimensions may vary slightly in products of this type. Not all units conform exactly to the dimensions noted.

PERTHESE™ BREAST IMPLANT SIZERS

Sterile Silicone Gel Breast Implant Sizers, Round Shapes

PERTHESE™ Breast Implants TX, Sterile Gel Sizers* Low Profile, Micro-Textured



Definitive Implant	Volume	Diameter	Projection	Catalog #
TX 100	100 cc	9,1 cm	2,2 cm	GABTX100STE
TX 125	125 cc	9,7 cm	2,4 cm	GABTX125STE
TX 150	150 cc	10,2 cm	2,6 cm	GABTX150STE
TX 170	170 cc	10,8 cm	2,7 cm	GABTX170STE
TX 185	185 cc	11,1 cm	2,8 cm	GABTX185STE
TX 200	200 cc	11,4 cm	2,9 cm	GABTX200STE
TX 220	220 cc	11,8 cm	2,9 cm	GABTX220STE
TX 240	240 cc	12,2 cm	3,0 cm	GABTX240STE
TX 260	260 cc	12,3 cm	3,1 cm	GABTX260STE
TX 280	280 cc	12,5 cm	3,2 cm	GABTX280STE
TX 300	300 cc	12,8 cm	3,2 cm	GABTX300STE
TX 325	325 cc	13,1 cm	3,3 cm	GABTX325STE
TX 350	350 cc	13,5 cm	3,4 cm	GABTX350STE

PERTHESE™ Breast Implants MX, Sterile Gel Sizers* Moderate Profile, Micro-Textured

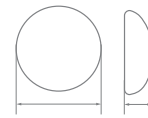

Definitive Implant	Volume	Diameter	Projection	Catalog #
MX 100	100 cc	8,7 cm	2,8 cm	GABMX100STE
MX 125	125 cc	9,2 cm	3,0 cm	GABMX125STE
MX 150	150 cc	9,9 cm	3,2 cm	GABMX150STE
MX 175	175 cc	10,4 cm	3,3 cm	GABMX175STE
MX 200	200 cc	11,0 cm	3,4 cm	GABMX200STE
MX 225	225 cc	11,5 cm	3,5 cm	GABMX225STE
MX 250	250 cc	12,0 cm	3,6 cm	GABMX250STE
MX 275	275 cc	12,2 cm	3,7 cm	GABMX275STE
MX 300	300 cc	12,5 cm	3,8 cm	GABMX300STE
MX 325	325 cc	12,8 cm	4,0 cm	GABMX325STE
MX 350	350 cc	13,0 cm	4,2 cm	GABMX350STE
MX 375	375 cc	13,2 cm	4,4 cm	GABMX375STE
MX 400	400 cc	13,5 cm	4,5 cm	GABMX400STE
MX 450	450 cc	13,9 cm	4,6 cm	GABMX450STE
MX 500	500 cc	14,2 cm	5,0 cm	GABMX500STE
MX 550	550 cc	14,5 cm	5,2 cm	GABMX550STE
MX 600	600 cc	14,9 cm	5,4 cm	GABMX600STE
MX 650	650 cc	15,2 cm	5,5 cm	GABMX650STE
MX 700	700 cc	15,6 cm	5,6 cm	GABMX700STE
MX 800	800 cc	16,1 cm	6,0 cm	GABMX800STE

*Sterile - Single Use Only

Note: Individual implant dimensions may vary slightly in products of this type.

Not all units will conform exactly to the dimensions noted above

PERTHESE™ BREAST IMPLANT SIZERS

Sterile Silicone Gel Breast Implant Sizers, Round Shapes CONT'D

PERTHESE™ Breast Implants 540, Sterile Gel Sizers* High Profile, Micro-Textured

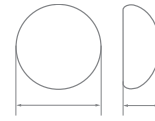

Definitive Implant	Volume	Diameter	Projection	Catalog #
540-075	75 cc	8,1 cm	2,3 cm	GAB540075STE
540-100	100 cc	8,2 cm	3,0 cm	GAB540100STE
540-125	125 cc	8,8 cm	3,2 cm	GAB540125STE
540-150	150 cc	9,2 cm	3,4 cm	GAB540150STE
540-175	175 cc	9,9 cm	3,6 cm	GAB540175STE
540-200	200 cc	10,1 cm	3,8 cm	GAB540200STE
540-230	230 cc	10,4 cm	4,0 cm	GAB540230STE
540-260	260 cc	11,0 cm	4,3 cm	GAB540260STE
540-280	280 cc	11,1 cm	4,4 cm	GAB540280STE
540-300	300 cc	11,2 cm	4,5 cm	GAB540300STE
540-325	325 cc	11,7 cm	4,6 cm	GAB540325STE
540-350	350 cc	11,9 cm	4,8 cm	GAB540350STE
540-380	380 cc	12,0 cm	4,9 cm	GAB540380STE
540-400	400 cc	12,1 cm	4,9 cm	GAB540400STE
540-440	440 cc	12,7 cm	5,3 cm	GAB540440STE
540-500	500 cc	13,2 cm	5,4 cm	GAB540500STE
540-550	550 cc	13,25 cm	5,9 cm	GAB540550STE
540-600	600 cc	13,8 cm	6,0 cm	GAB540600STE
540-650	650 cc	14,2 cm	6,1 cm	GAB540650STE
540-850	850 cc	15,5 cm	6,7 cm	GAB540850STE

*Sterile - Single Use Only

PERTHESE™ BREAST IMPLANT SIZERS

Sterile Inflatable Sizers, Round Shapes

PERTHESE™ Breast Implants TX, Sterile Inflatable Sizers* Low Profile, Micro-Textured



Definitive Implant	Volume	Diameter	Projection	Catalog #
TX 100	100 cc	9,1 cm	2,2 cm	GGSTX100
TX 125	125 cc	9,7 cm	2,4 cm	GGSTX125
TX 150	150 cc	10,2 cm	2,6 cm	GGSTX150
TX 170	170 cc	10,8 cm	2,7 cm	GGSTX170
TX 185	185 cc	11,1 cm	2,8 cm	GGSTX185
TX 200	200 cc	11,4 cm	2,9 cm	GGSTX200
TX 220	220 cc	11,8 cm	2,9 cm	GGSTX220
TX 240	240 cc	12,2 cm	3,0 cm	GGSTX240
TX 260	260 cc	12,3 cm	3,1 cm	GGSTX260
TX 280	280 cc	12,5 cm	3,2 cm	GGSTX280
TX 300	300 cc	12,8 cm	3,2 cm	GGSTX300
TX 325	325 cc	13,1 cm	3,3 cm	GGSTX325
TX 350	350 cc	13,5 cm	3,4 cm	GGSTX350

PERTHESE™ Breast Implants MX, Sterile Inflatable Sizers* Moderate Profile, Micro-Textured



Definitive Implant	Volume	Diameter	Projection	Catalog #
MX 125	125 cc	9,2 cm	3,0 cm	GGSMX125
MX 150	150 cc	9,9 cm	3,2 cm	GGSMX150
MX 175	175 cc	10,4 cm	3,3 cm	GGSMX175
MX 200	200 cc	11,0 cm	3,4 cm	GGSMX200
MX 225	225 cc	11,5 cm	3,5 cm	GGSMX225
MX 250	250 cc	12,0 cm	3,6 cm	GGSMX250
MX 275	275 cc	12,2 cm	3,7 cm	GGSMX275
MX 300	300 cc	12,5 cm	3,8 cm	GGSMX300
MX 325	325 cc	12,8 cm	4,0 cm	GGSMX325
MX 350	350 cc	13,0 cm	4,2 cm	GGSMX350
MX 375	375 cc	13,2 cm	4,4 cm	GGSMX375
MX 400	400 cc	13,5 cm	4,5 cm	GGSMX400

*Sterile - Single Use Only

Note: Individual implant dimensions may vary slightly in products of this type.
Not all units will conform exactly to the dimensions noted above

PERTHESE™ BREAST IMPLANT SIZERS

Sterile Inflatable Sizers, Round Shapes CONT'D

PERTHESE™ Breast Implants 540, Sterile Inflatable Sizers* High Profile, Micro-Textured

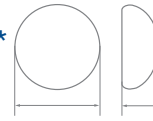

Definitive Implant	Volume	Diameter	Projection	Catalog #
540-200	200 cc	10,1 cm	3,8 cm	GG540200
540-230	230 cc	10,4 cm	4,0 cm	GG540230
540-260	260 cc	11,0 cm	4,3 cm	GG540260
540-280	280 cc	11,1 cm	4,4 cm	GG540280
540-300	300 cc	11,2 cm	4,5 cm	GG540300
540-325	325 cc	11,7 cm	4,6 cm	GG540325
540-350	350 cc	11,9 cm	4,8 cm	GG540350
540-380	380 cc	12,0 cm	4,9 cm	GG540380
540-400	400 cc	12,1 cm	4,9 cm	GG540400

*Sterile - Single Use Only

PERTHESE™ ESTHEA BREAST IMPLANT SIZERS

Sterile Silicone Gel Breast Implant Sizers, Anatomical Shapes

PERTHESE™ Esthea Breast Implants, Sterile Gel Sizers* ELP - EHP - ESHP, Micro-Textured



Definitive Implant	Volume	Width	Height	Projection	A	Inferior Curve Length	Superior Curve Length	Catalog #
ELP 190	190 cc	10,0 cm	12,5 cm	3,5 cm	3,6 cm	4,8 cm	9,2 cm	GABELP190STE
EHP 225	225 cc	10,0 cm	12,5 cm	4,0 cm	3,6 cm	5,6 cm	9,5 cm	GABEHP225STE
ESHP 235	235 cc	10,0 cm	12,5 cm	4,6 cm	3,5 cm	5,7 cm	9,5 cm	GABESHP235STE
ELP 240	240 cc	11,1 cm	13,8 cm	3,6 cm	3,7 cm	5,0 cm	10,2 cm	GABELP240STE
EHP 275	275 cc	11,1 cm	13,8 cm	4,2 cm	3,7 cm	5,8 cm	10,6 cm	GABEHP275STE
ESHP 295	295 cc	11,1 cm	13,8 cm	4,8 cm	3,7 cm	6,1 cm	10,6 cm	GABESHP295STE
ELP 270	270 cc	11,7 cm	14,0 cm	3,9 cm	4,1 cm	5,5 cm	10,3 cm	GABELP270STE
EHP 325	325 cc	11,7 cm	14,0 cm	4,7 cm	4,1 cm	6,4 cm	10,6 cm	GABEHP325STE
ESHP 355	355 cc	11,7 cm	14,0 cm	5,3 cm	4,0 cm	6,8 cm	10,7 cm	GABESHP355STE
ELP 310	310 cc	12,3 cm	14,4 cm	4,2 cm	4,3 cm	6,0 cm	10,4 cm	GABELP310STE
EHP 375	375 cc	12,3 cm	14,4 cm	5,1 cm	4,3 cm	6,8 cm	10,8 cm	GABEHP375STE
ESHP 415	415 cc	12,3 cm	14,4 cm	5,6 cm	4,3 cm	7,2 cm	10,9 cm	GABESHP415STE
ELP 360	360 cc	12,6 cm	14,8 cm	4,5 cm	4,7 cm	6,4 cm	10,5 cm	GABELP360STE
EHP 425	425 cc	12,6 cm	14,8 cm	5,4 cm	4,7 cm	7,4 cm	10,9 cm	GABEHP425STE
ESHP 475	475 cc	12,6 cm	14,8 cm	5,9 cm	4,7 cm	7,9 cm	11,1 cm	GABESHP475STE

PERTHESE™ Esthea Breast Implants, Sterile Gel Sizers* AX, Micro-Textured

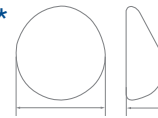

Definitive Implant	Volume	Width	Height	Projection	A	Inferior Curve Length	Superior Curve Length	Catalog #
AX 190	190 cc	10,6 cm	10,8 cm	4,3 cm	3,7 cm	5,8 cm	7,8 cm	GABAX190STE
AX 210	210 cc	10,9 cm	11,2 cm	4,4 cm	3,8 cm	6,0 cm	8,2 cm	GABAX210STE
AX 240	240 cc	11,5 cm	12,2 cm	4,6 cm	3,9 cm	6,1 cm	8,8 cm	GABAX240STE
AX 260	260 cc	11,9 cm	12,5 cm	4,8 cm	4,0 cm	6,3 cm	9,1 cm	GABAX260STE
AX 285	285 cc	12,1 cm	12,8 cm	4,9 cm	4,1 cm	6,4 cm	9,4 cm	GABAX285STE
AX 300	300 cc	12,6 cm	13,2 cm	4,9 cm	4,2 cm	6,6 cm	9,6 cm	GABAX300STE
AX 340	340 cc	12,9 cm	13,7 cm	4,9 cm	4,4 cm	6,9 cm	10,0 cm	GABAX340STE
AX 380	380 cc	13,3 cm	14,1 cm	5,0 cm	4,6 cm	7,2 cm	10,2 cm	GABAX380STE
AX 400	400 cc	13,6 cm	14,2 cm	5,1 cm	4,7 cm	7,4 cm	10,3 cm	GABAX400STE
AX 450	450 cc	13,9 cm	14,7 cm	5,2 cm	4,8 cm	7,5 cm	10,8 cm	GABAX450STE
AX 480	480 cc	14,5 cm	15,2 cm	5,3 cm	4,9 cm	7,7 cm	11,2 cm	GABAX480STE
AX 500	500 cc	14,9 cm	15,6 cm	5,3 cm	5,0 cm	7,9 cm	11,5 cm	GABAX500STE

*Sterile - Single Use Only

Note: Individual implant dimensions may vary slightly in products of this type.

Not all units will conform exactly to the dimensions noted above

PERTHESE™ ESTHEA BREAST IMPLANT SIZERS

Sterile Silicone Gel Breast Implant Sizers, Anatomical Shapes CONT'D

PERTHESE™ Esthea Breast Implants, Sterile Gel Sizers* EMP, Micro-Textured



Definitive Implant	Volume	Width	Height	Projection	A	Inferior Curve Length	Superior Curve Length	Catalog #
EMP 080	80 cc	8,1 cm	6,8 cm	3,2 cm	2,4 cm	3,7 cm	4,9 cm	GABEMP080STE
EMP 100	100 cc	8,6 cm	7,3 cm	3,5 cm	2,7 cm	4,2 cm	5,3 cm	GABEMP100STE
EMP 120	120 cc	9,2 cm	7,7 cm	3,6 cm	2,9 cm	4,5 cm	5,5 cm	GABEMP120STE
EMP 145	145 cc	10,2 cm	8,5 cm	3,9 cm	3,2 cm	5,0 cm	6,1 cm	GABEMP145STE
EMP 165	165 cc	10,7 cm	9,1 cm	4,0 cm	3,4 cm	5,3 cm	6,4 cm	GABEMP165STE
EMP 200	200 cc	11,2 cm	9,6 cm	4,3 cm	3,6 cm	5,7 cm	6,8 cm	GABEMP200STE
EMP 230	230 cc	11,7 cm	10,1 cm	4,5 cm	3,8 cm	6,0 cm	7,2 cm	GABEMP230STE
EMP 265	265 cc	12,2 cm	10,6 cm	4,6 cm	3,9 cm	6,1 cm	7,6 cm	GABEMP265STE
EMP 305	305 cc	12,7 cm	11,1 cm	4,9 cm	4,1 cm	6,4 cm	7,9 cm	GABEMP305STE
EMP 345	345 cc	13,1 cm	11,6 cm	5,0 cm	4,4 cm	6,8 cm	8,2 cm	GABEMP345STE
EMP 390	390 cc	13,6 cm	12,0 cm	5,2 cm	4,6 cm	7,2 cm	8,5 cm	GABEMP390STE
EMP 435	435 cc	14,0 cm	12,5 cm	5,5 cm	4,8 cm	7,5 cm	8,9 cm	GABEMP435STE
EMP 475	475 cc	14,6 cm	13,0 cm	5,7 cm	4,9 cm	7,7 cm	9,2 cm	GABEMP475STE
EMP 535	535 cc	15,1 cm	13,3 cm	5,9 cm	5,0 cm	8,1 cm	9,6 cm	GABEMP535STE
EMP 585	585 cc	15,5 cm	13,6 cm	6,1 cm	5,2 cm	8,4 cm	9,8 cm	GABEMP585STE

*Sterile - Single Use Only

PERTHESE™ ESTHEA BREAST IMPLANT SIZERS

Sterile Inflatable Sizers, Anatomical Shapes

PERTHESE™ Esthea Breast Implants, Sterile Inflatable Sizers* ELP - EHP - ESHP, Micro-Textured



Definitive Implant	Volume	Width	Height	Projection	A	Inferior Curve Length	Superior Curve Length	Catalog #
ELP 190	190 cc	10,0 cm	12,5 cm	3,5 cm	3,6 cm	4,8 cm	9,2 cm	GGSELP190
EHP 225	225 cc	10,0 cm	12,5 cm	4,0 cm	3,6 cm	5,6 cm	9,5 cm	GGSEHP225
ESHP 235	235 cc	10,0 cm	12,5 cm	4,6 cm	3,5 cm	5,7 cm	9,5 cm	GGSEHP235
ELP 240	240 cc	11,1 cm	13,8 cm	3,6 cm	3,7 cm	5,0 cm	10,2 cm	GGSELP240
EHP 275	275 cc	11,1 cm	13,8 cm	4,2 cm	3,7 cm	5,8 cm	10,6 cm	GGSEHP275
ESHP 295	295 cc	11,1 cm	13,8 cm	4,8 cm	3,7 cm	6,1 cm	10,6 cm	GGSEHP295
ELP 270	270 cc	11,7 cm	14,0 cm	3,9 cm	4,1 cm	5,5 cm	10,3 cm	GGSELP270
EHP 325	325 cc	11,7 cm	14,0 cm	4,7 cm	4,1 cm	6,4 cm	10,6 cm	GGSEHP325
ESHP 355	355 cc	11,7 cm	14,0 cm	5,3 cm	4,0 cm	6,8 cm	10,7 cm	GGSEHP355
ELP 310	310 cc	12,3 cm	14,4 cm	4,2 cm	4,3 cm	6,0 cm	10,4 cm	GGSELP310
EHP 375	375 cc	12,3 cm	14,4 cm	5,1 cm	4,3 cm	6,8 cm	10,8 cm	GGSEHP375
ESHP 415	415 cc	12,3 cm	14,4 cm	5,6 cm	4,3 cm	7,2 cm	10,9 cm	GGSEHP415
ELP 360	360 cc	12,6 cm	14,8 cm	4,5 cm	4,7 cm	6,4 cm	10,5 cm	GGSELP360
EHP 425	425 cc	12,6 cm	14,8 cm	5,4 cm	4,7 cm	7,4 cm	10,9 cm	GGSEHP425
ESHP 475	475 cc	12,6 cm	14,8 cm	5,9 cm	4,7 cm	7,9 cm	11,1 cm	GGSEHP475

PERTHESE™ Esthea Breast Implants, Sterile Inflatable Sizers* AX, Micro-Textured

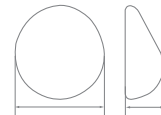

Definitive Implant	Volume	Width	Height	Projection	A	Inferior Curve Length	Superior Curve Length	Catalog #
AX 240	240 cc	11,5 cm	12,2 cm	4,6 cm	3,9 cm	6,1 cm	8,8 cm	GG SAX240
AX 260	260 cc	11,9 cm	12,5 cm	4,8 cm	4,0 cm	6,3 cm	9,1 cm	GG SAX260
AX 285	285 cc	12,1 cm	12,8 cm	4,9 cm	4,1 cm	6,4 cm	9,4 cm	GG SAX285
AX 300	300 cc	12,6 cm	13,2 cm	4,9 cm	4,2 cm	6,6 cm	9,6 cm	GG SAX300
AX 340	340 cc	12,9 cm	13,7 cm	4,9 cm	4,4 cm	6,9 cm	10,0 cm	GG SAX340
AX 380	380 cc	13,3 cm	14,1 cm	5,0 cm	4,6 cm	7,2 cm	10,2 cm	GG SAX380
AX 400	400 cc	13,6 cm	14,2 cm	5,1 cm	4,7 cm	7,4 cm	10,3 cm	GG SAX400

*Sterile - Single Use Only

Note: Individual implant dimensions may vary slightly in products of this type.

Not all units will conform exactly to the dimensions noted above

Sterile Inflatable Sizers,
Anatomical Shapes CONT'D

PERTHESE™ Esthea Breast Implants, Sterile Inflatable Sizers*
EMP, Micro-Textured

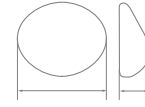

Definitive Implant	Volume	Width	Height	Projection	A	Inferior Curve Length	Superior Curve Length	Catalog #
EMP 120	120 cc	9,2 cm	7,7 cm	3,6 cm	2,9 cm	4,5 cm	5,5 cm	GGSEMP120
EMP 145	145 cc	10,2 cm	8,5 cm	3,9 cm	3,2 cm	5,0 cm	6,1 cm	GGSEMP145
EMP 165	165 cc	10,7 cm	9,1 cm	4,0 cm	3,4 cm	5,3 cm	6,4 cm	GGSEMP165
EMP 200	200 cc	11,2 cm	9,6 cm	4,3 cm	3,6 cm	5,7 cm	6,8 cm	GGSEMP200
EMP 230	230 cc	11,7 cm	10,1 cm	4,5 cm	3,8 cm	6,0 cm	7,2 cm	GGSEMP230
EMP 265	265 cc	12,2 cm	10,6 cm	4,6 cm	3,9 cm	6,1 cm	7,6 cm	GGSEMP265
EMP 305	305 cc	12,7 cm	11,1 cm	4,9 cm	4,1 cm	6,4 cm	7,9 cm	GGSEMP305
EMP 345	345 cc	13,1 cm	11,6 cm	5,0 cm	4,4 cm	6,8 cm	8,2 cm	GGSEMP345
EMP 390	390 cc	13,6 cm	12,0 cm	5,2 cm	4,6 cm	7,2 cm	8,5 cm	GGSEMP390
EMP 435	435 cc	14,0 cm	12,5 cm	5,5 cm	4,8 cm	7,5 cm	8,9 cm	GGSEMP435
EMP 475	475 cc	14,6 cm	13,0 cm	5,7 cm	4,9 cm	7,7 cm	9,2 cm	GGSEMP475
EMP 535	535 cc	15,1 cm	13,3 cm	5,9 cm	5,0 cm	8,1 cm	9,6 cm	GGSEMP535
EMP 585	585 cc	15,5 cm	13,6 cm	6,1 cm	5,2 cm	8,4 cm	9,8 cm	GGSEMP585

*Sterile - Single Use Only

Important Safety Information

MENTOR® Breast Implants are indicated for breast augmentation, in women who are at least 18 years old, or for breast reconstruction. Breast implant surgery should not be performed in women with active infection anywhere in their body, with existing cancer or pre-cancer of their breast(s) who have not received adequate treatment for those conditions or who are pregnant or nursing.

There are risks associated with breast implant surgery. Breast implants are not lifetime devices and breast implantation is not necessarily a one-time surgery.

The most common complications with MENTOR® MemoryGel™ Breast Implants and PERTHESE™ Breast Implants include re-operation, implant removal, capsular contracture, asymmetry, and breast pain. A lower risk of complication is implant rupture, which is most often silent. The health consequences of a ruptured silicone gel-filled breast implant have not been fully established. Screenings such as mammography, MRI, or ultrasound are recommended after initial implant surgery to assist in detecting implant rupture.

The most common complications with MENTOR® Saline-Filled Implants include re-operation, implant removal, capsular contracture, wrinkling, deflation, asymmetry, and breast pain.

MENTOR® CONTOUR PROFILE™ Tissue Expanders and MENTOR® Smooth Round Tissue Expanders with Remote Dome are used for breast reconstruction following mastectomy. These expanders are intended for temporary subcutaneous or submuscular implantation and are not intended for use beyond six months. CONTOUR PROFILE™ Tissue Expanders are devices that contain magnetic injection domes and are NOT MRI compatible. Do not use the CONTOUR PROFILE™ Tissue Expander in patients where an MRI may be needed. DO NOT use the CONTOUR PROFILE™ Tissue Expander in patients that have a previously implanted device that could be affected by a magnetic field. The device could be moved by the MRI causing pain or displacement, potentially resulting in a revision surgery. The incidence of extrusion of the expander has been shown to increase when the expander has been placed in injured areas: scarred, heavily irradiated or burned tissue, crushed bone areas or where severe surgical reduction of the area has previously been performed.

Your patient needs to be informed and understand the risks and benefits of breast implants, and provided with an opportunity to consult with you prior to deciding on surgery.

For detailed indications, contraindications, warning and precautions associated with the use of all MENTOR® Implantable Devices, please refer to the Product Insert Data Sheet provided with each product, or review the Important Safety Information provided at www.mentorwwllc.eu

Our Credo

We believe our first responsibility is to the doctors, nurses and patients, to mothers and fathers and all others who use our products and services. In meeting their needs everything we do must be of high quality. We must constantly strive to reduce our costs in order to maintain reasonable prices. Customers' orders must be serviced promptly and accurately. Our suppliers and distributors must have an opportunity to make a fair profit.

We are responsible to our employees, the men and women who work with us throughout the world. Everyone must be considered as an individual. We must respect their dignity and recognize their merit. They must have a sense of security in their jobs. Compensation must be fair and adequate, and working conditions clean, orderly and safe. We must be mindful of ways to help our employees fulfill their family responsibilities. Employees must feel free to make suggestions and complaints. There must be equal opportunity for employment, development and advancement for those qualified. We must provide competent management, and their actions must be just and ethical.

We are responsible to the communities in which we live and work and to the world community as well. We must be good citizens – support good works and charities and bear our fair share of taxes. We must encourage civic improvements and better health and education. We must maintain in good order the property we are privileged to use, protecting the environment and natural resources.

Our final responsibility is to our stockholders. Business must make a sound profit. We must experiment with new ideas. Research must be carried on, innovative programs developed and mistakes paid for. New equipment must be purchased, new facilities provided and new products launched. Reserves must be created to provide for adverse times. When we operate according to these principles, the stockholders should realize a fair return.



A division of Johnson & Johnson Medical Limited
Pinewood Campus, Nine Mile Ride, Wokingham
Berkshire, RG40 3EW
Customer Service 0800 973 082
contact@medgb.jnj.com
www.mentormedical.co.uk